

## A Mysterious Fellow

### ACROSS

1. Part of a baseball cap
5. Type of shoppe
9. Chops or whittles down
13. Clean up in the backyard, maybe
14. Half of quatre
15. Word that often hangs from a hallway ceiling
16. 56-Across, once
18. Verdi opera with the refrain "Immenso Fthà" ("Mighty Ptah")
19. Goopy black stuff
20. Peekaboo player
22. Young cod or haddock, deboned for cooking
25. 56-Across?
26. 56-Across
28. Knot
29. \_\_\_ Lingus (Irish carrier)
30. Participated in a marathon, say
32. "The Lord of the Rings"-type stories
36. 56-Across
40. Where an eagle lives
41. "Act your \_\_\_!"
42. Disco guy on "The Simpsons"
43. Catch some Z's
45. 56-Across?
48. 56-Across?
52. "It's \_\_\_!" ("No doubt!")
53. Disheartening view from the crow's nest, maybe
54. Close, like a coat
55. Perform on "American Idol"
56. [Circled letters] guy
61. "Mi casa \_\_\_ casa"
62. Shakespearean title character
63. Horemheb's successor
64. George of the Jungle's elephant buddy
65. Regarding
66. "Fool me \_\_\_, ..."

### DOWN

1. Top half of a bikini, basically
2. Bash into

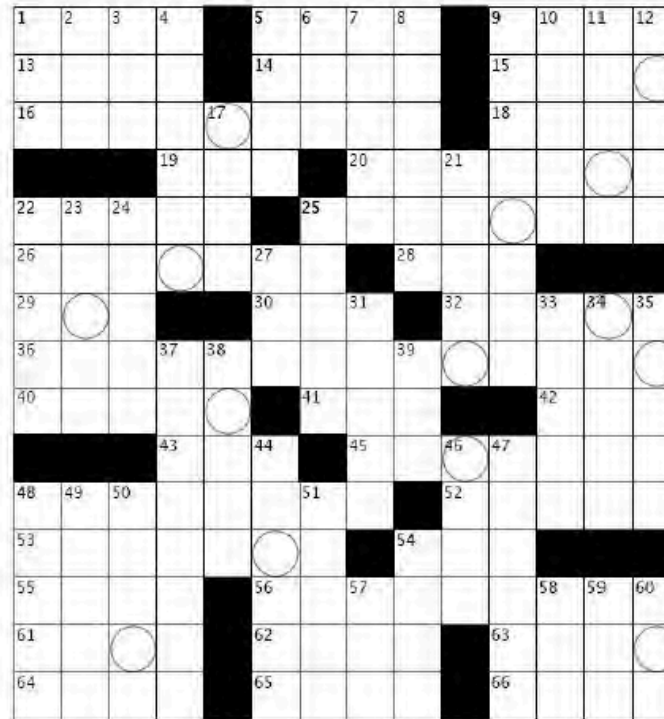

3. Kyle's little Canadian brother on "South Park"
4. Obi-Wan, to Luke
5. You'll find it at a fish market
6. Allow
7. On account of
8. Petroleum is a big one for Egypt
9. Social life killer for a junior high kid
10. Banish
11. Add a lane to, maybe
12. Space near the gingerbread plum trees and the peppermint forest
17. "If I Only \_\_\_ Brain"
21. 18th-century believer in both God and reason
22. Digging tool
23. Having a lot of gristle
24. Medium, vis-à-vis medium-well
25. Zdeno \_\_\_, first 6'9" N.H.L. player
27. Load from a lode
31. Good time to see Mars or Jupiter
33. Verve
34. Place for old books or records
35. Open, as an oyster
37. Getting ready to go into Best Buy on Black Friday
38. Flips (through)
39. Word between two last names
44. \_\_\_ mode (classic dessert combo)
46. Puddles gather it up
47. City across the Rio Grande from Juárez
48. Sits for a photoshoot
49. Gorillalike
50. Perfume, as at a ceremony
51. Drink orders at a sushi bar
54. Total loser
57. Jester's accessory
58. Looker
59. "Yada yada yada ..."
60. "Bill \_\_\_, the Science Guy"

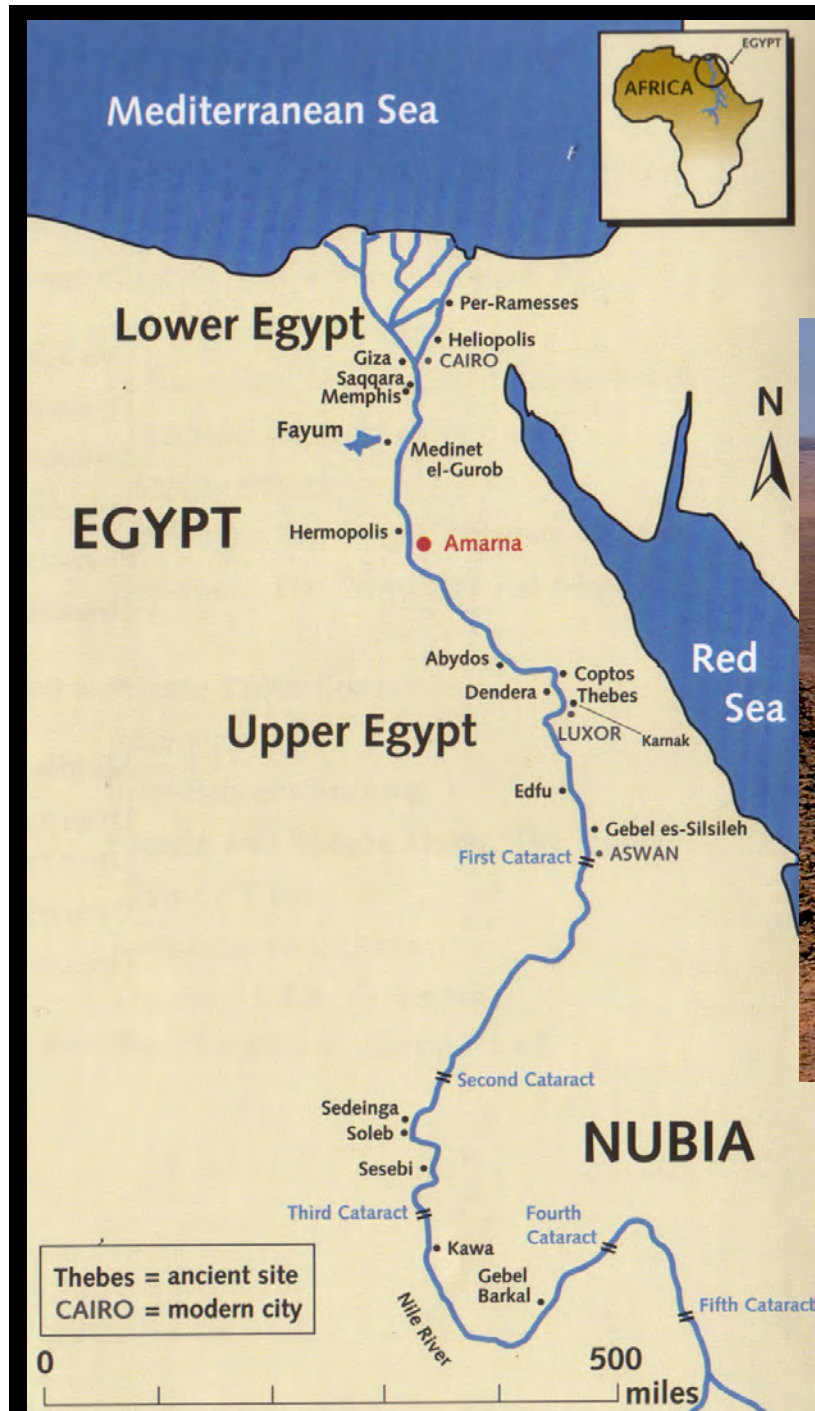

The site of Akhetaten/Amarna



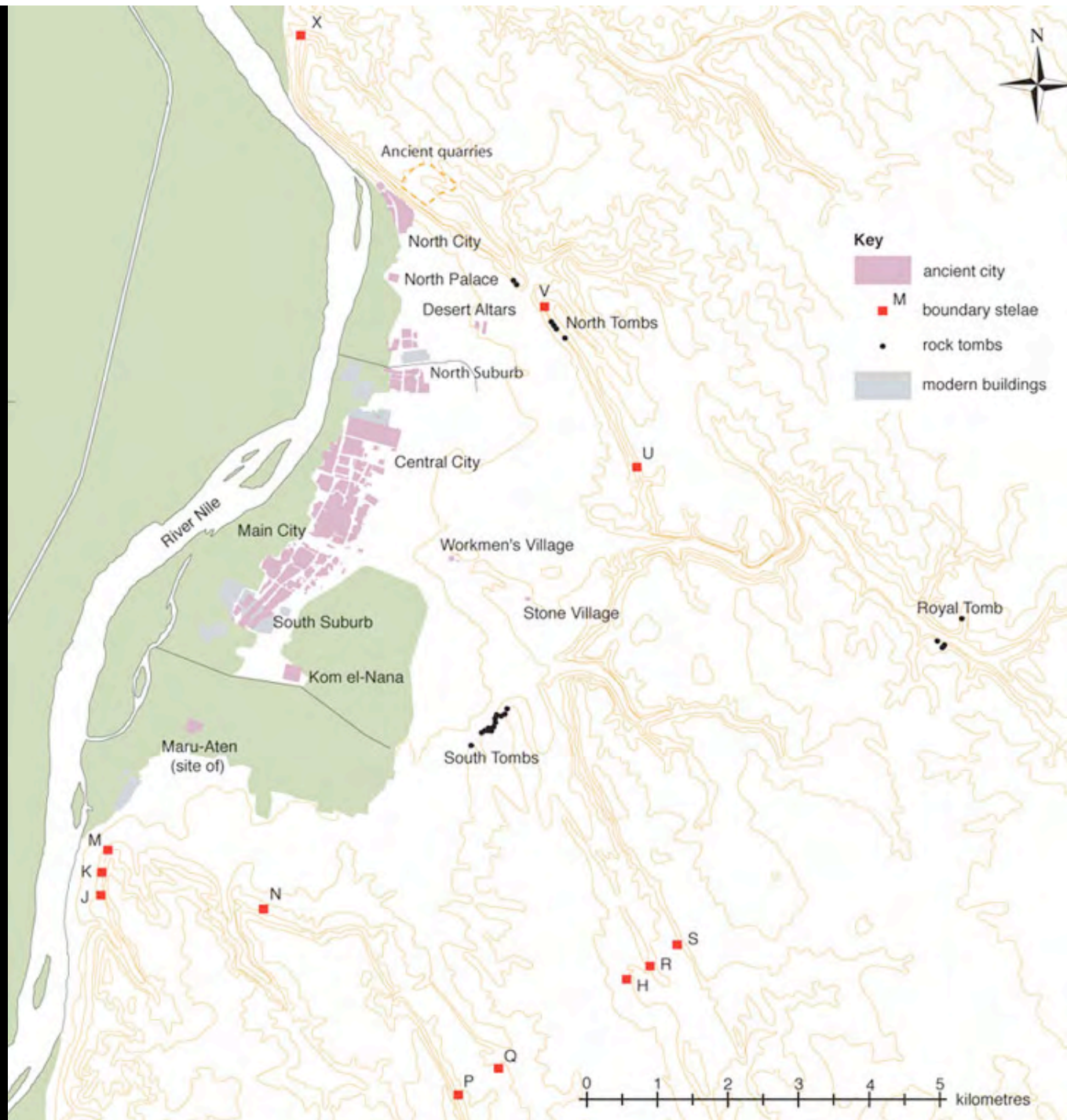



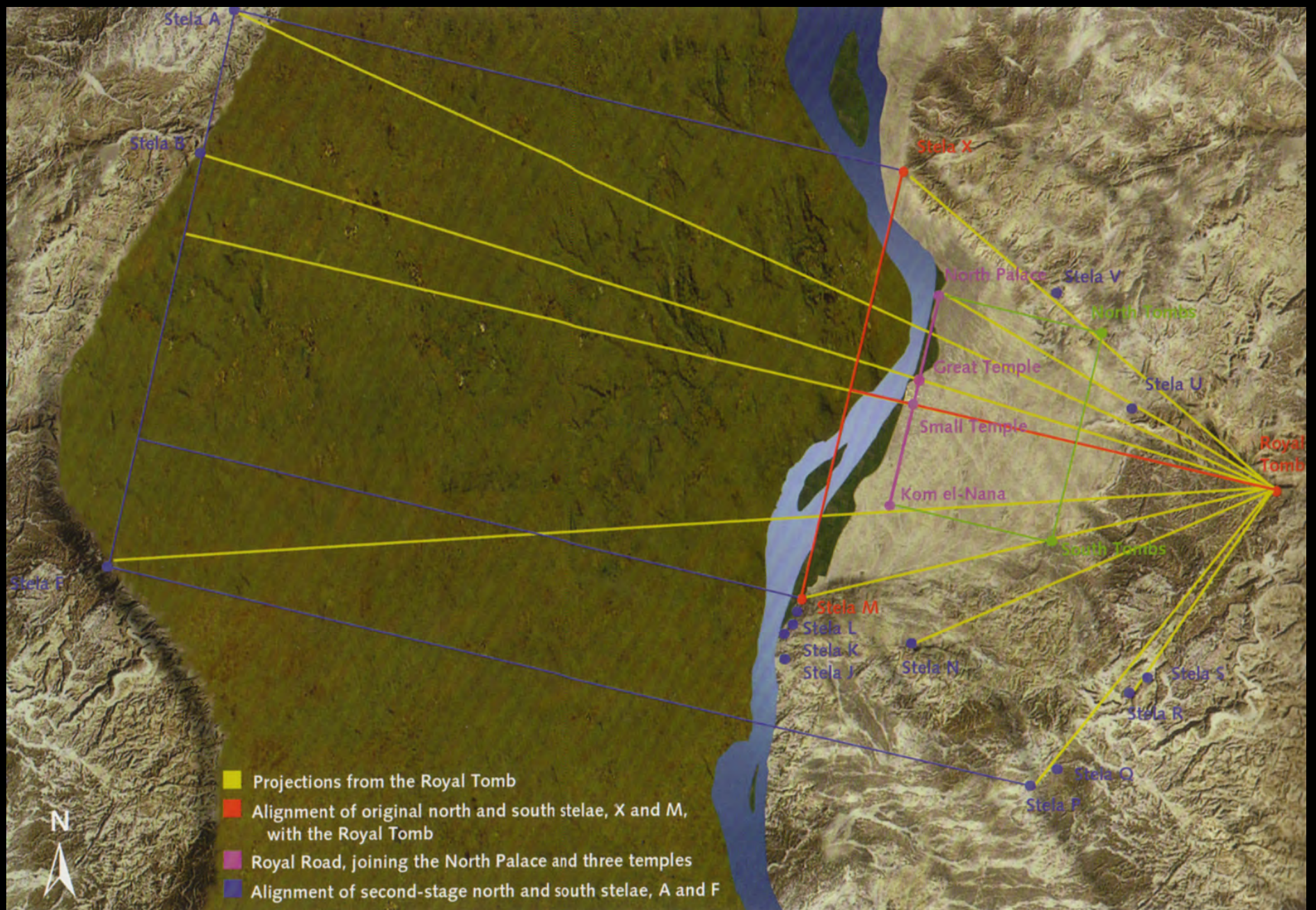





Boundary stelae at Amarna; that on the right is from Year 6, the second round of stela erection





From the Year 5 boundary stelae:

On this day, when One was in Akhet-Aten, his Person appeared on the great chariot of electrum – just like Aten, when he rises in his horizon and fills the land with the love and the pleasantness of the Aten. He set off on a good road toward Akhet-Aten, his place of the primeval event...

A great oblation was presented to the Father, Hor-Aten...

After this One performed the rites of the Aten, who was pleased with what was done for him...

His Person stood in the presence of his father, Hor-Aten, as Aten's rays were upon him...

Then his Person said "Bring me the king's companions and the great ones of the palace, the supervisors of the guard, the overseers of works projects, the officials and all the court in its entirety." So they were led in to him at once, and they lay on their bellies in his Person's presence, kissing the ground before the good god. Then said his Person to them "Behold Aten! The Aten wishes to have something made for him as a monument with an eternal and everlasting name. Now it is the Aten, my father, who advises me concerning it, namely Akhet-Aten. No official had ever advised me concerning it, nor had any people in the entire land ever advised me concerning it, to tell me a plan for making Akhet-Aten in this distant place.



... Then said the companions as they replied to the good god...

“May his lordship govern from Akhet-Aten. May you conduct every land to him. May you tax the towns and islands for him. Every city down to every [...], its entirety belongs to Aten, acting in accordance with what he himself ordains. All flat lands, all hill countries and the islands of the sea are bearing their tribute, their products on their backs, to the maker of their life, at the seeing of whose rays one lives...

“I shall make Akhet-Aten for the Aten, my father, in this place...

At Akhet-Aten in this place I shall make the House of Aten (the whole city) for the Aten, my father.

At Akhet-Aten in this place I shall make the Mansion of Aten (the great Aten temple) for the Aten, my father...

At Akhet-Aten in this place I shall make the sunshade (mortuary temple?) of the King's Chief Wife Neferneferuaten-Nefertiti for the Aten, my father...

At Akhet-Aten in this place I shall make for myself the residence of Pharaoh, I.p.h. and I shall make the residence of the King's Chief Wife.

Let a tomb be made for me in the east mountain of Akhet-Aten, and let my burial be made in it...”



# CENTRAL CITY OF AMARNA MODEL - SCALE 1:400

0 400m  
N

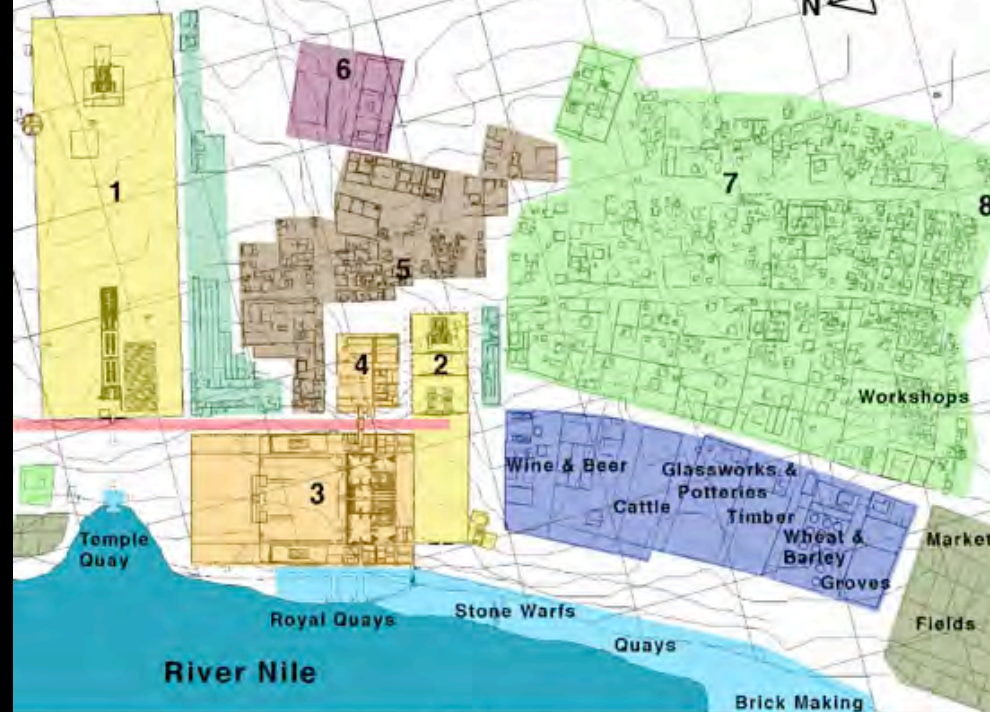

## KEY

1. Great Aten Temple
2. Small Aten Temple
3. Great Palace
4. King's House

5. House of Correspondence
6. Military Barracks
7. South Suburb
8. Thutmose Workshop

Temples & Altar Fields:  
Ritual offering to the Aten

Military Barracks:  
Patrolling of City boundary

Temple Storehouses & Bakery:  
Offering preparation & storage

Houses, Wells & Workshops:  
Residence, watering and craft

Royal Palaces & Court:  
Royal administration of court

Government Compounds:  
Goods storage & manufacture

Palace Storehouses & Offices:  
Government administration

Local Markets & Fields:  
Food sale & farming

Royal Road:  
Ceremonial Chariot Route

Quays, Boats & Brickyards:  
Shipping, trade & brickmaking

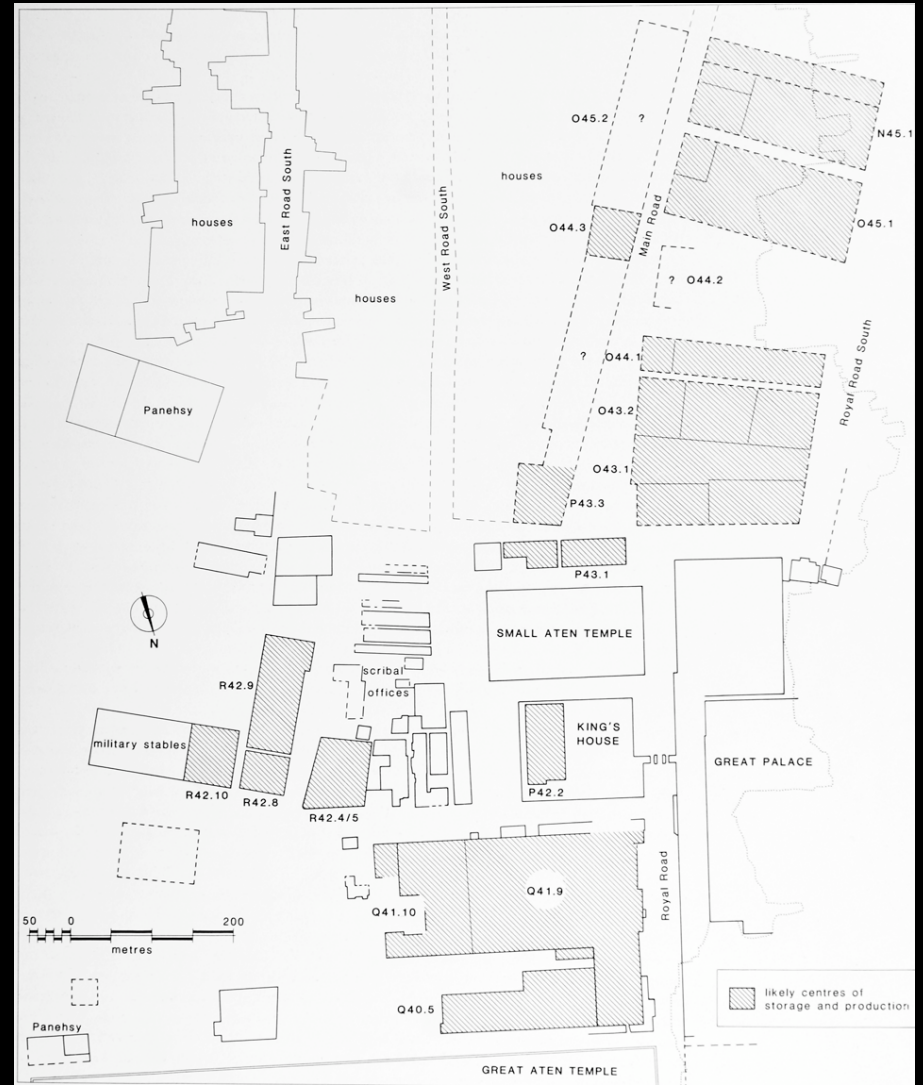
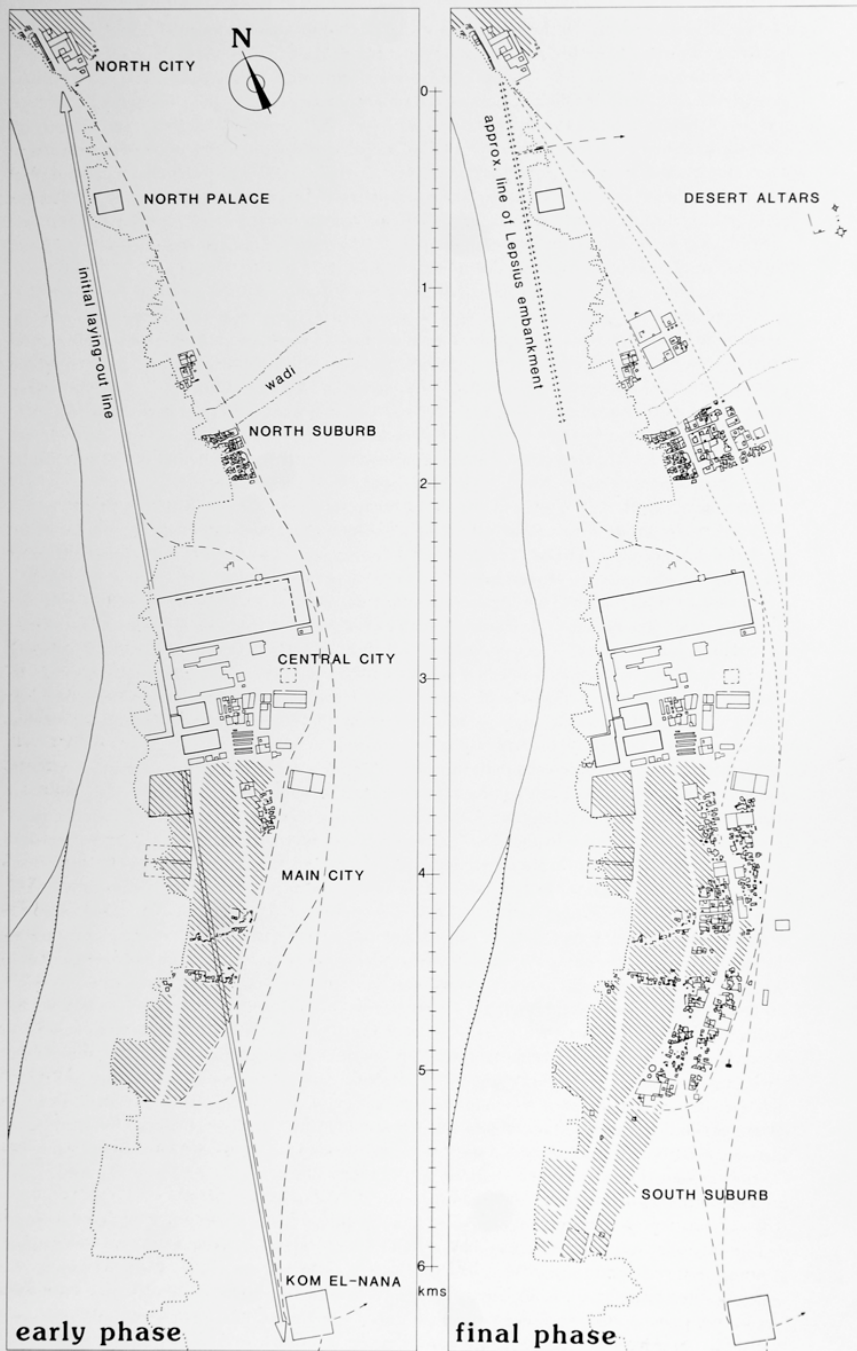

12. Block plan showing the principal administrative areas in the Central City and Main City.

Amarna and central city with production areas shown





Tools for understanding Amarna on the web:

Google Earth

The Amarna model:

[http://www.amarnaproject.com/pages/model\\_of\\_the\\_city/index.shtml](http://www.amarnaproject.com/pages/model_of_the_city/index.shtml)



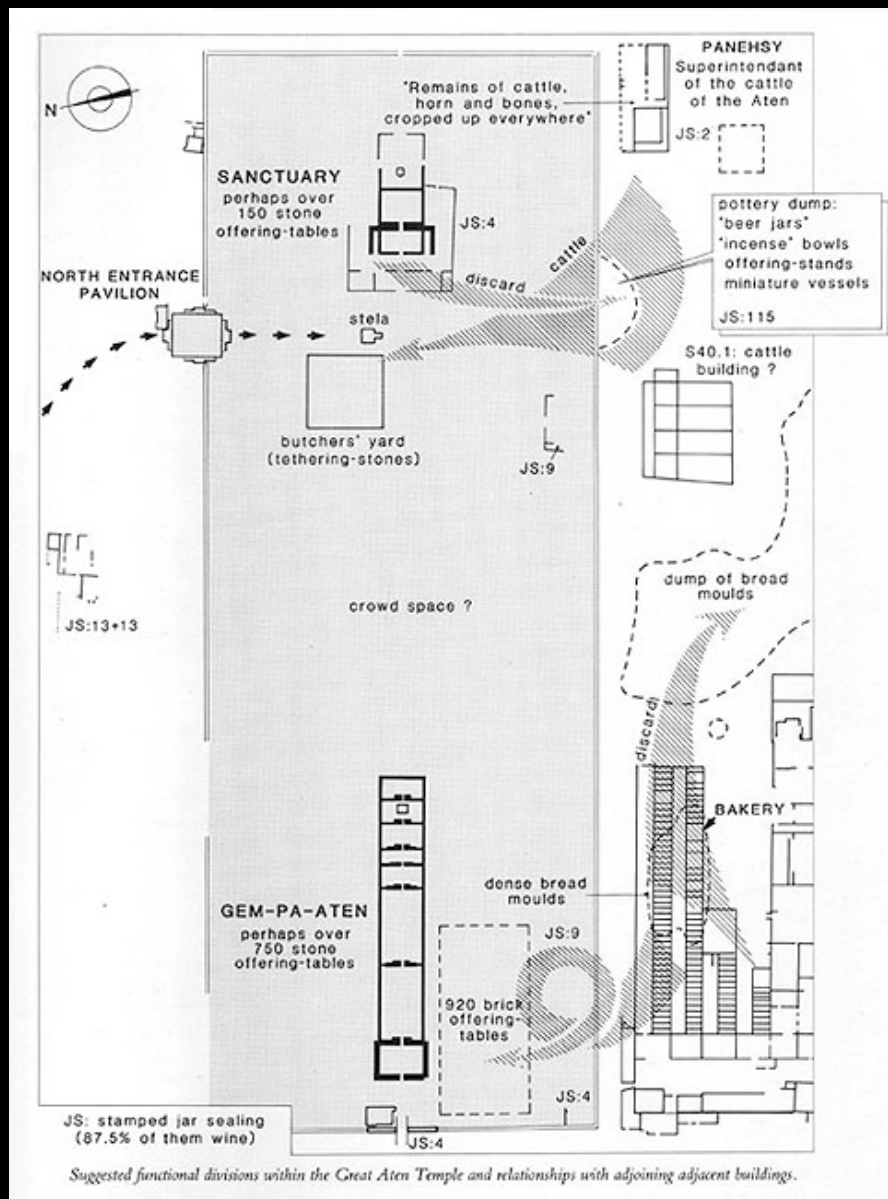

Plan of Great Temple and associated buildings; model looking south from Central City, Gempaaten in foreground



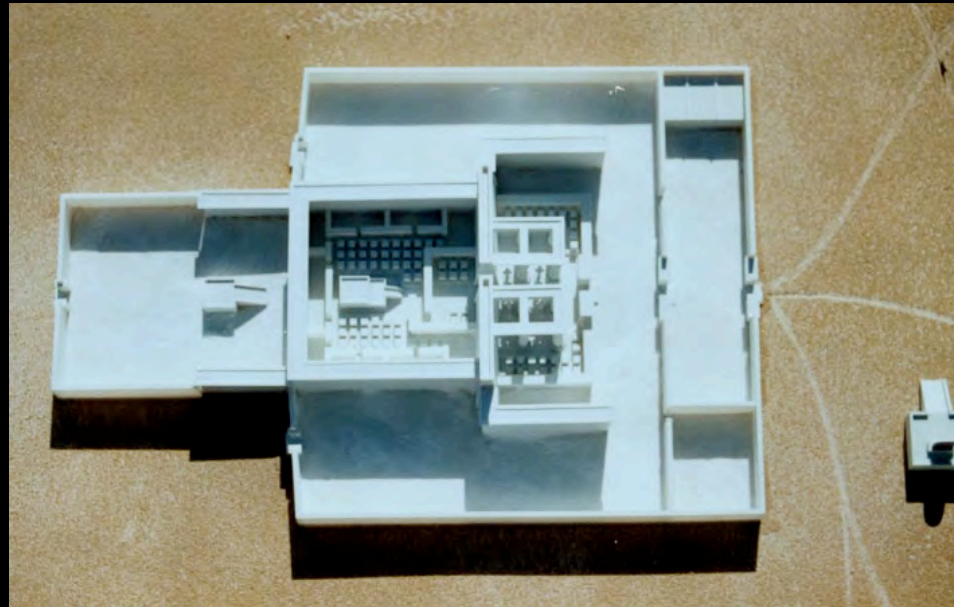

Great Temple Sanctuary  
(and stela)



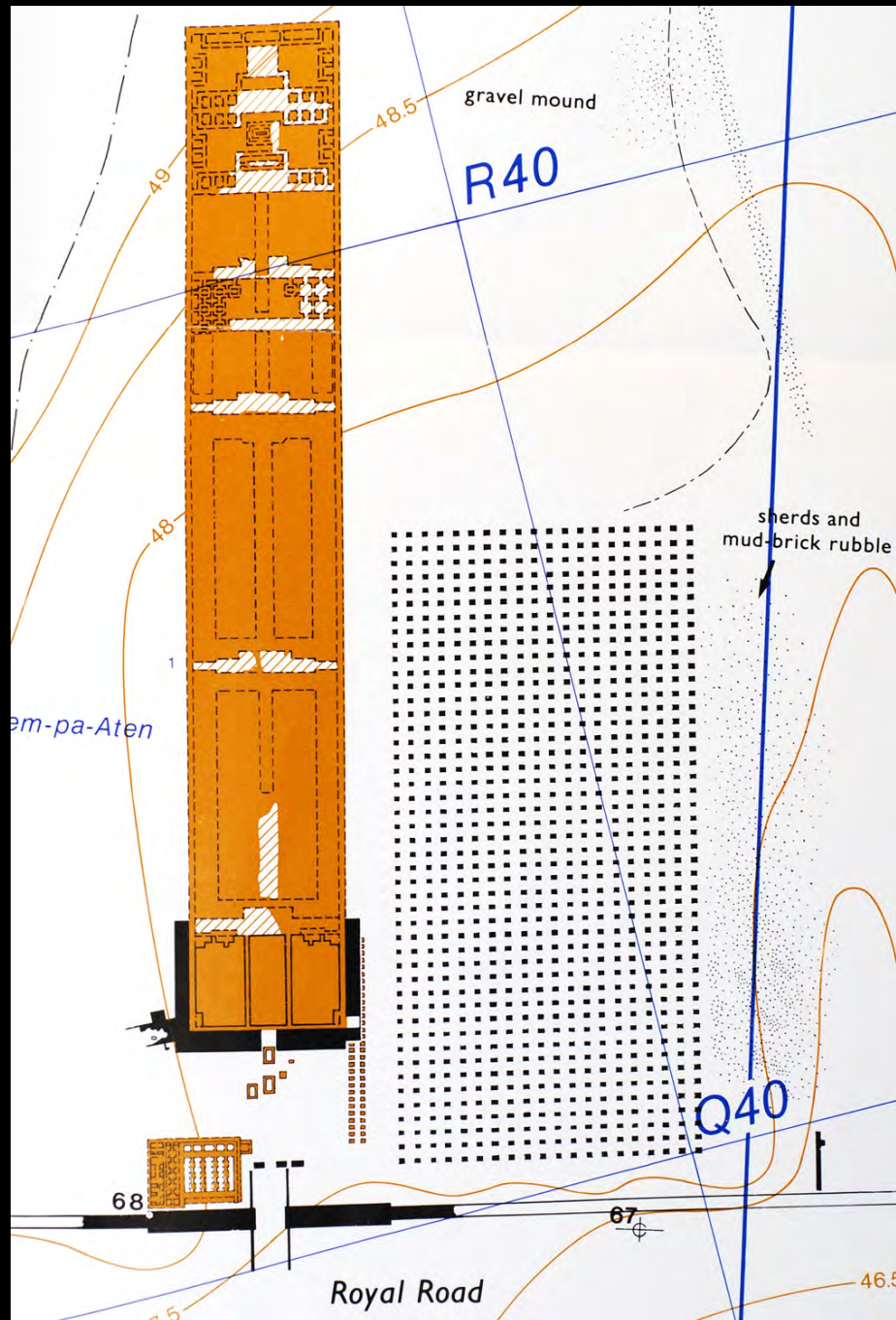

Great Aten Temple: Gempaaten

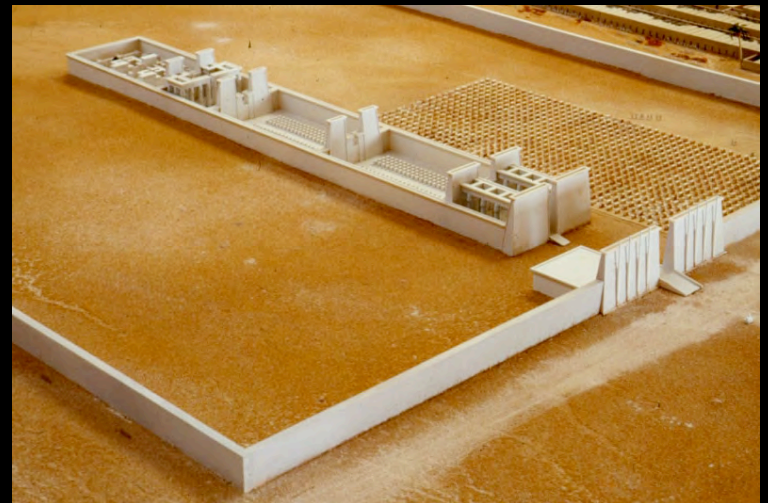



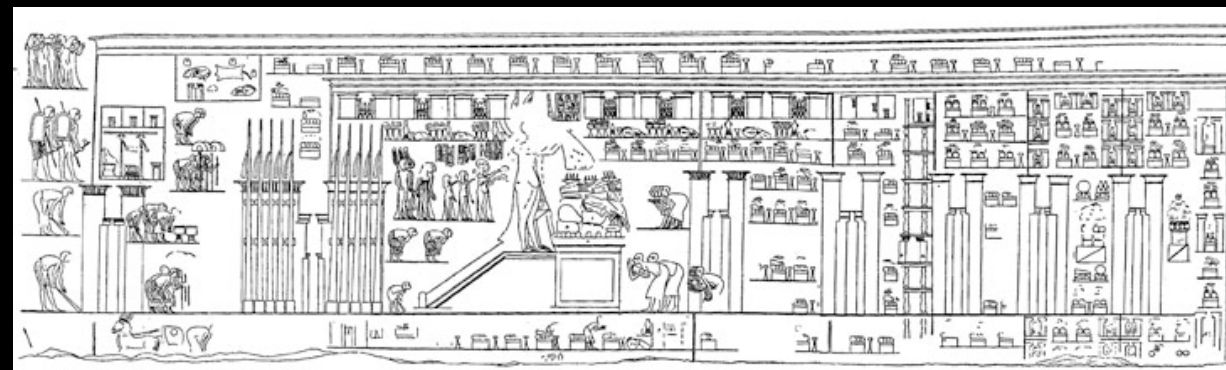
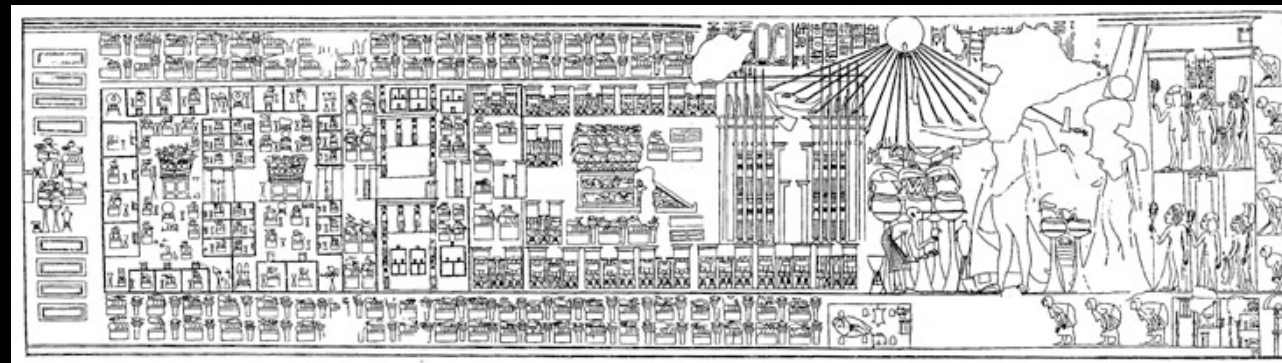
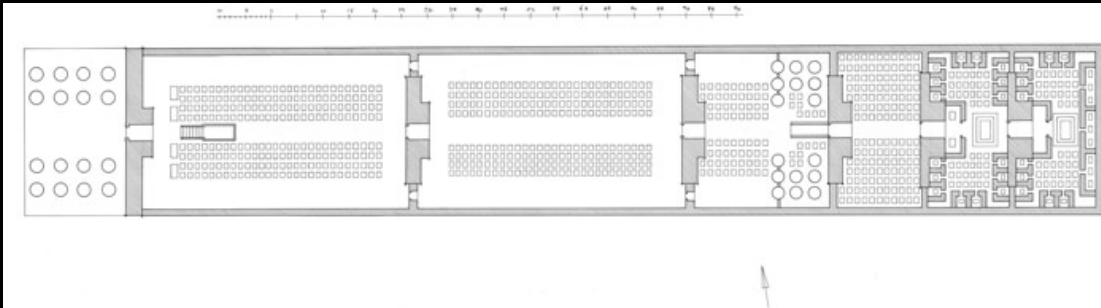

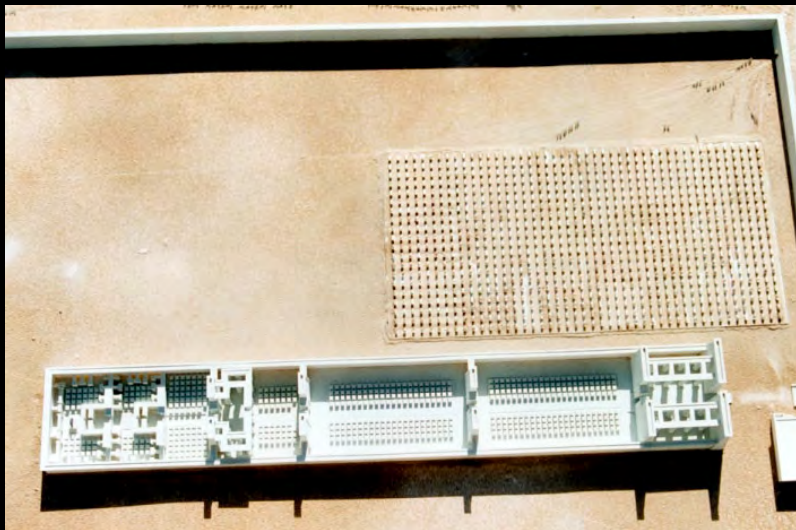
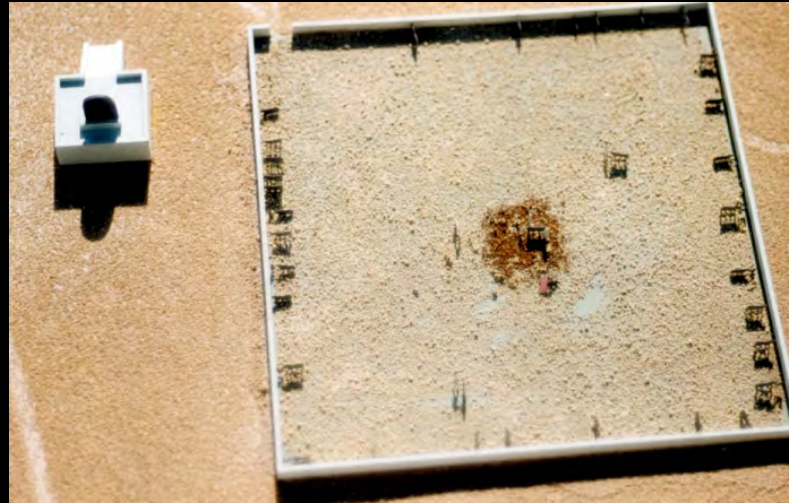



# CENTRAL CITY OF AMARNA MODEL - SCALE 1:400

0 400m  
N

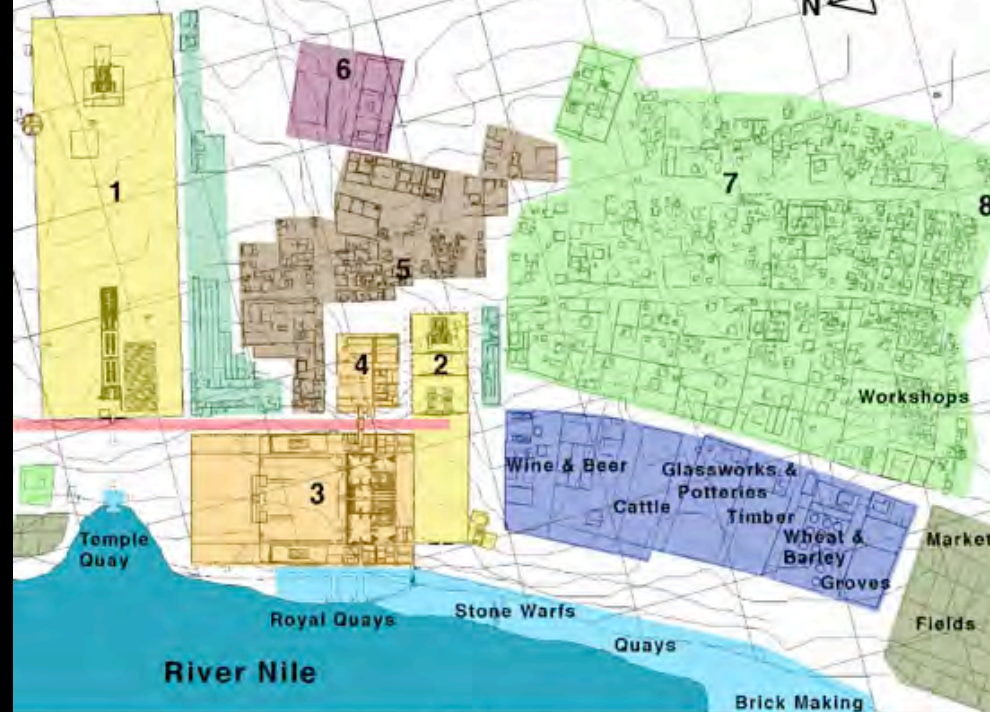

## KEY

1. Great Aten Temple
2. Small Aten Temple
3. Great Palace
4. King's House

5. House of Correspondence
6. Military Barracks
7. South Suburb
8. Thutmose Workshop

Temples & Altar Fields:  
Ritual offering to the Aten

Military Barracks:  
Patrolling of City boundary

Temple Storehouses & Bakery:  
Offering preparation & storage

Houses, Wells & Workshops:  
Residence, watering and craft

Royal Palaces & Court:  
Royal administration of court

Government Compounds:  
Goods storage & manufacture

Palace Storehouses & Offices:  
Government administration

Local Markets & Fields:  
Food sale & farming

Royal Road:  
Ceremonial Chariot Route

Quays, Boats & Brickyards:  
Shipping, trade & brickmaking





Model view of Small Aten Temple (before "Smenkhkare" Hall)

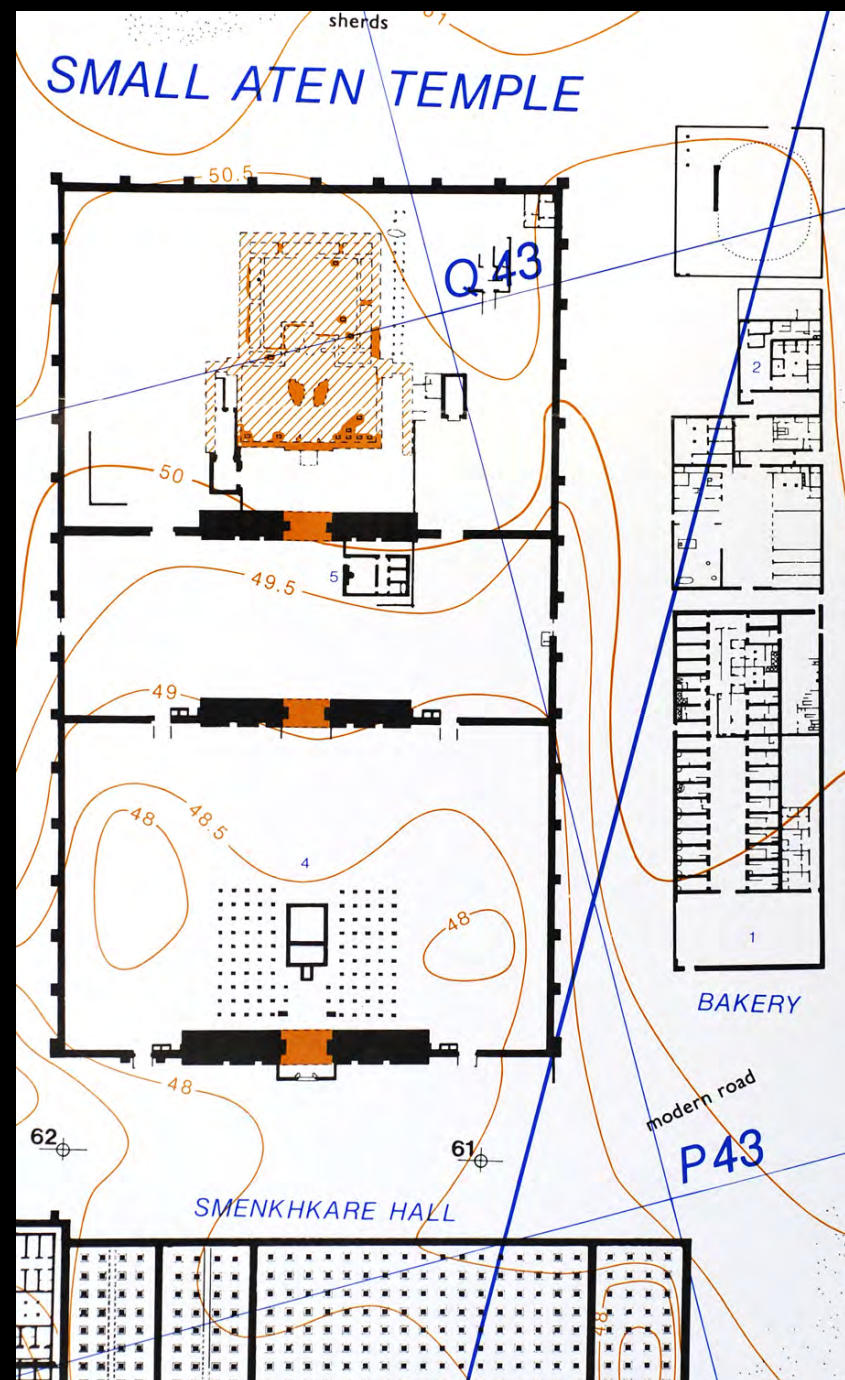







Akhetaten/Amarna: Central City, Great Palace area



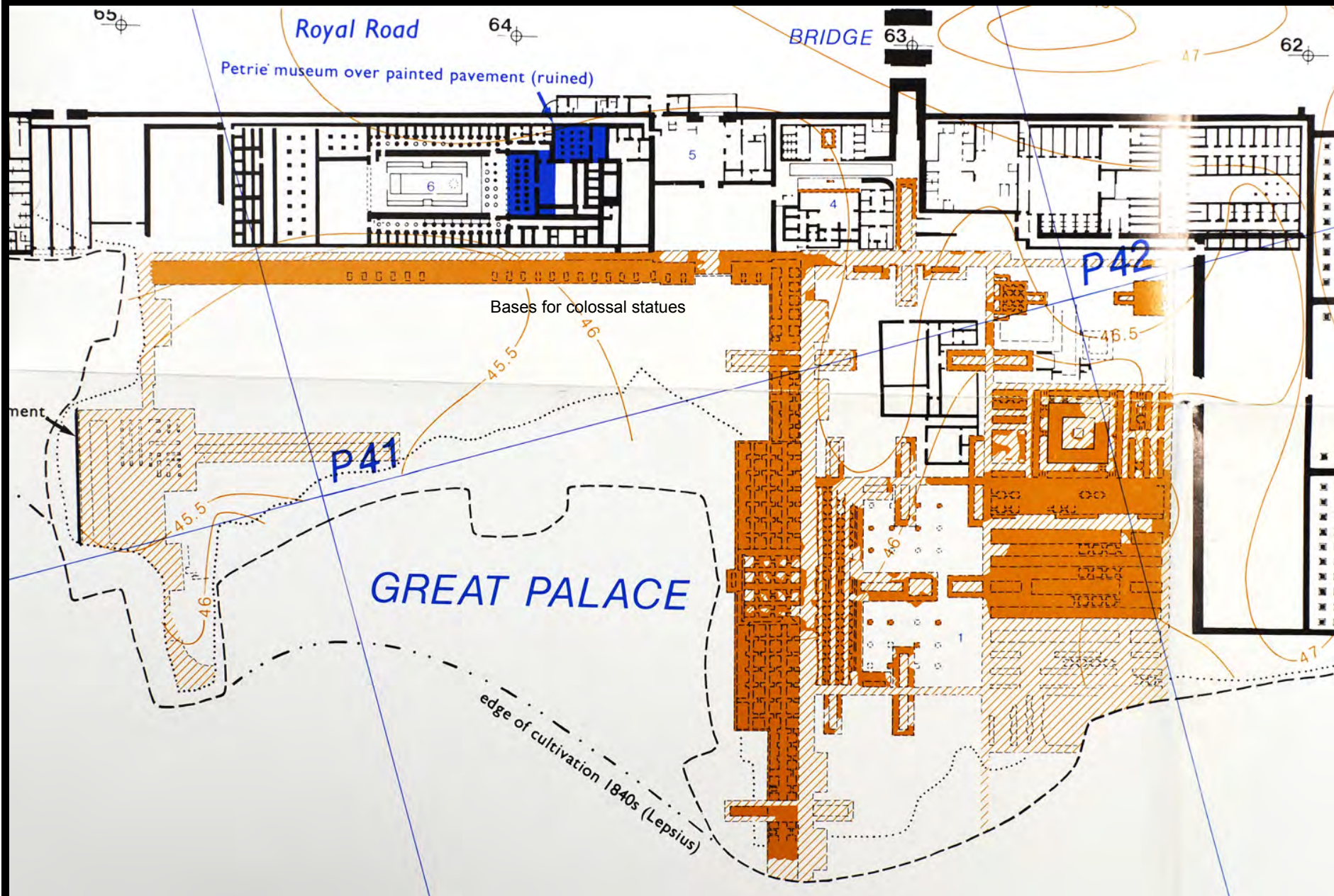





Bridge and 'King's House', Central

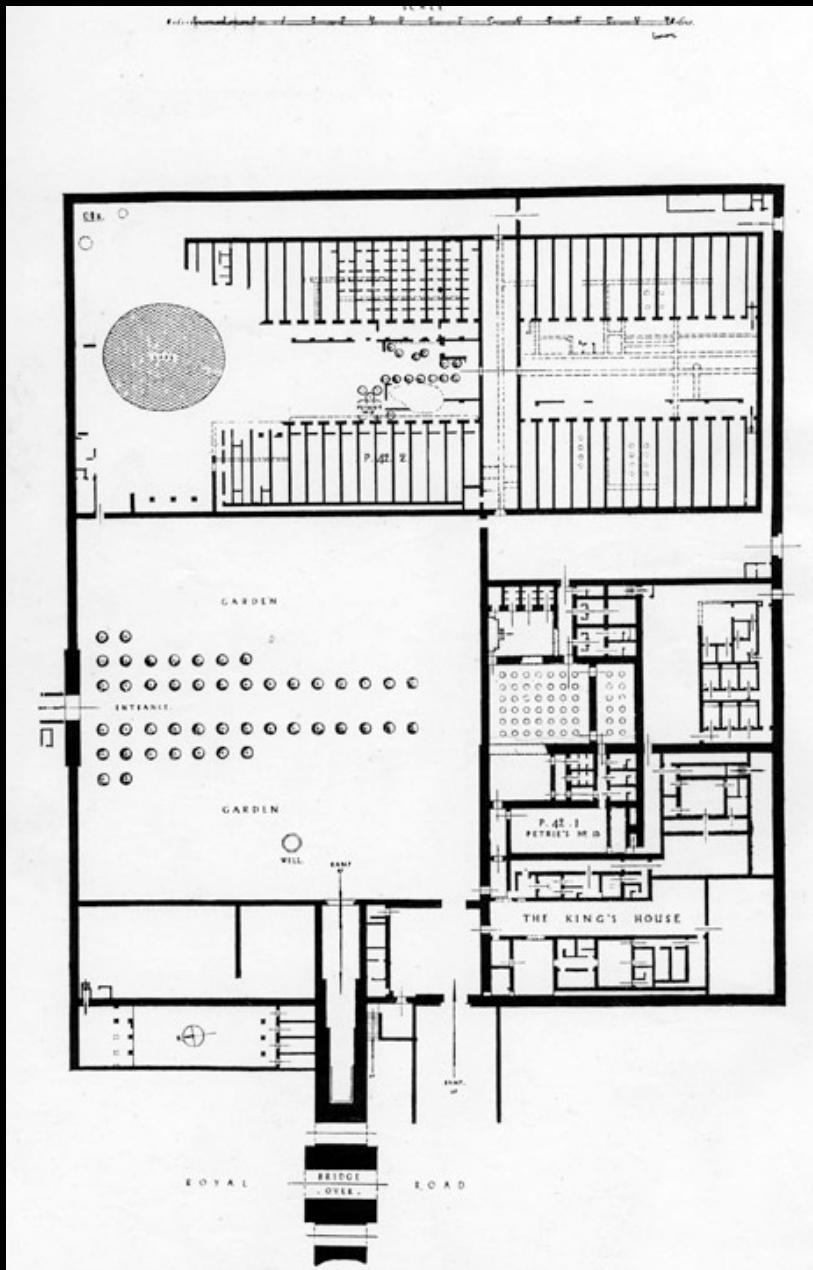
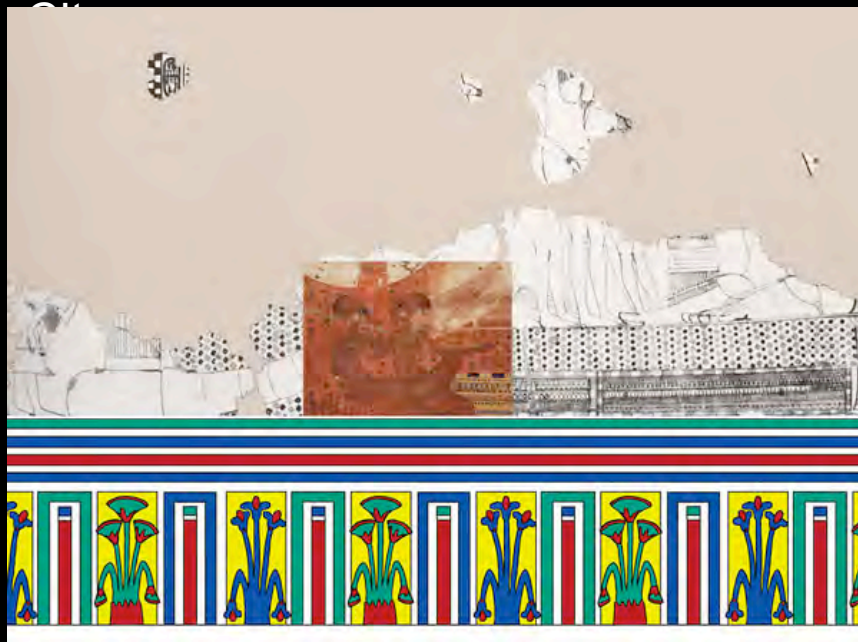



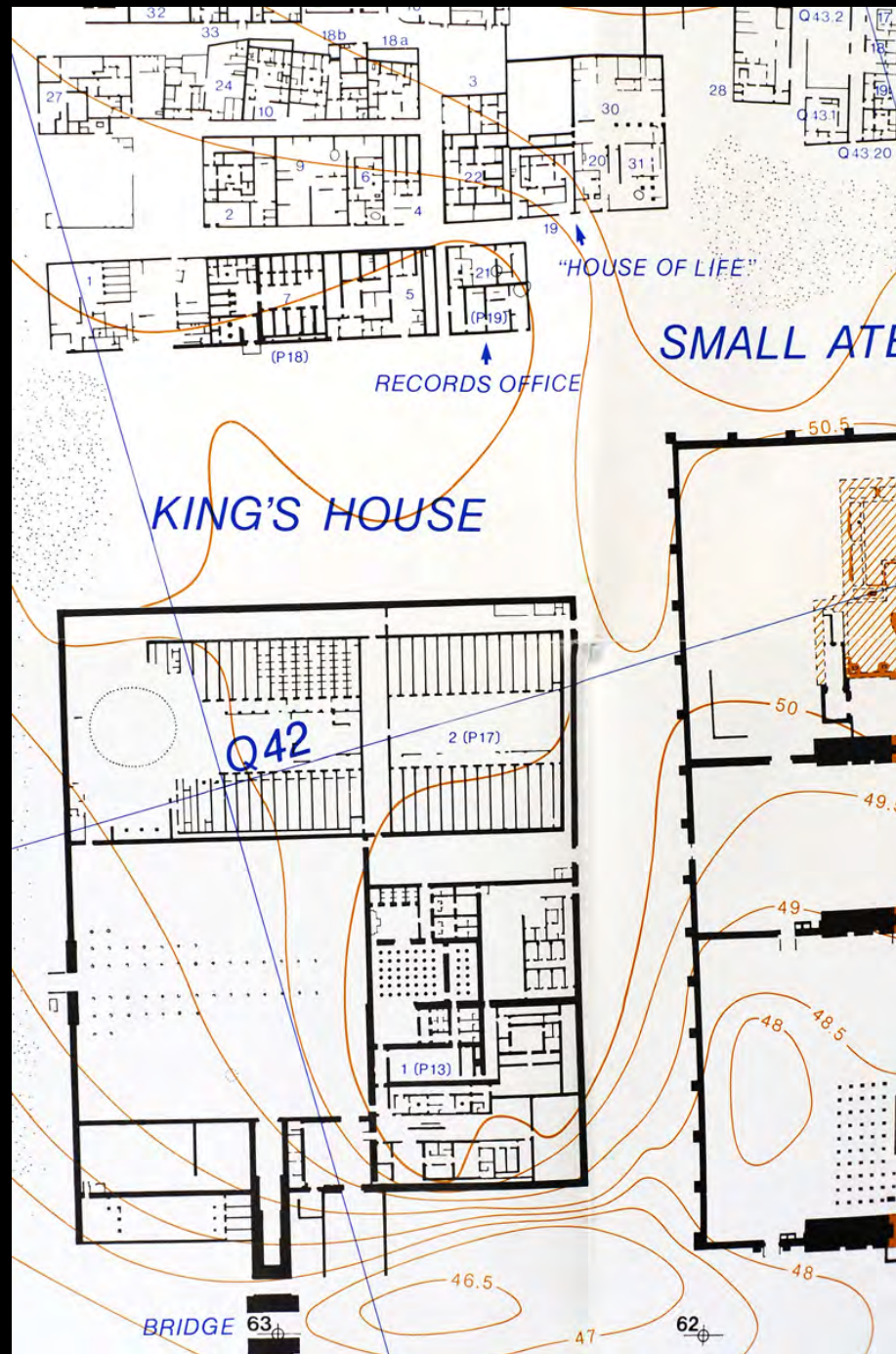

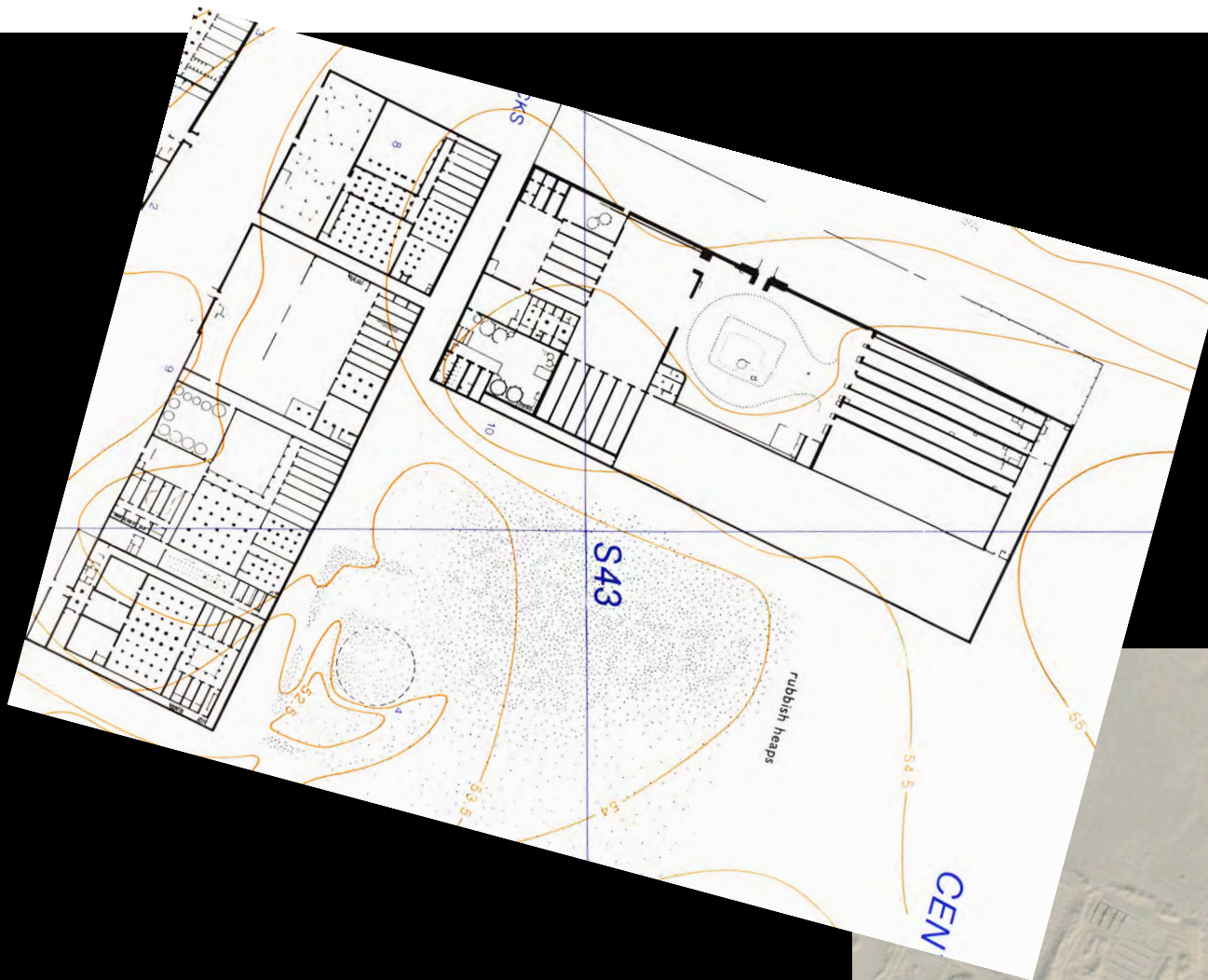

Military area with barracks





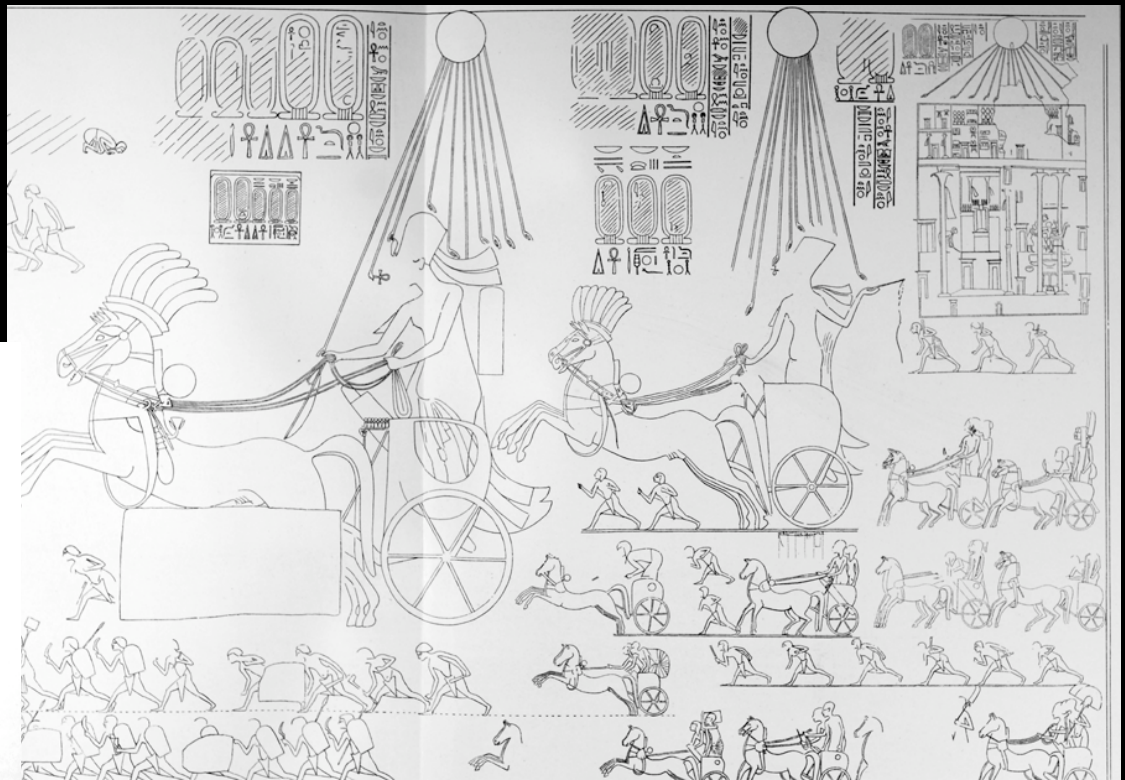
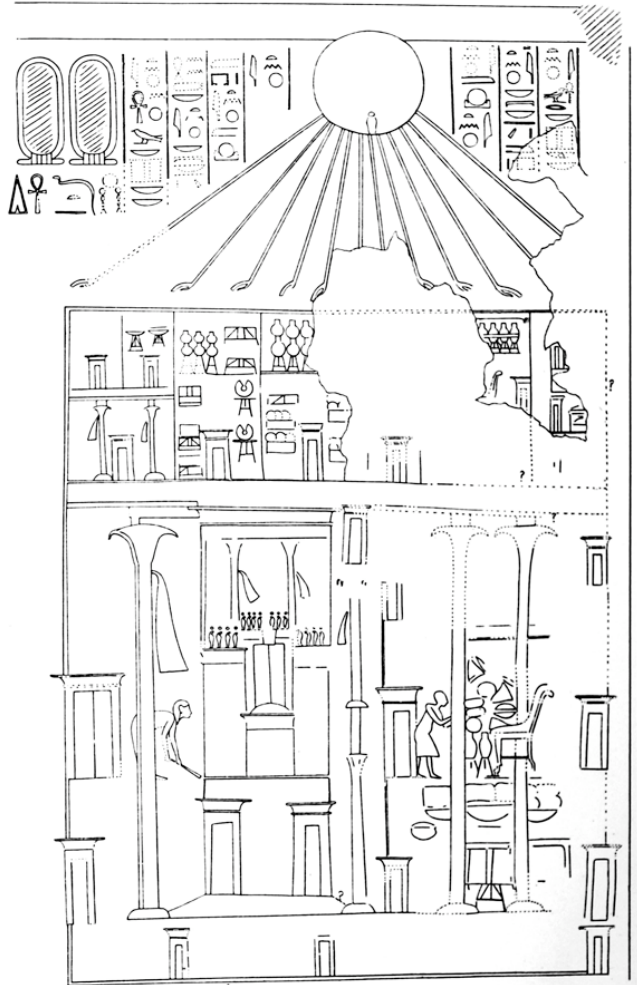

Akhenaten and family traveling  
between the Central City and  
palaces

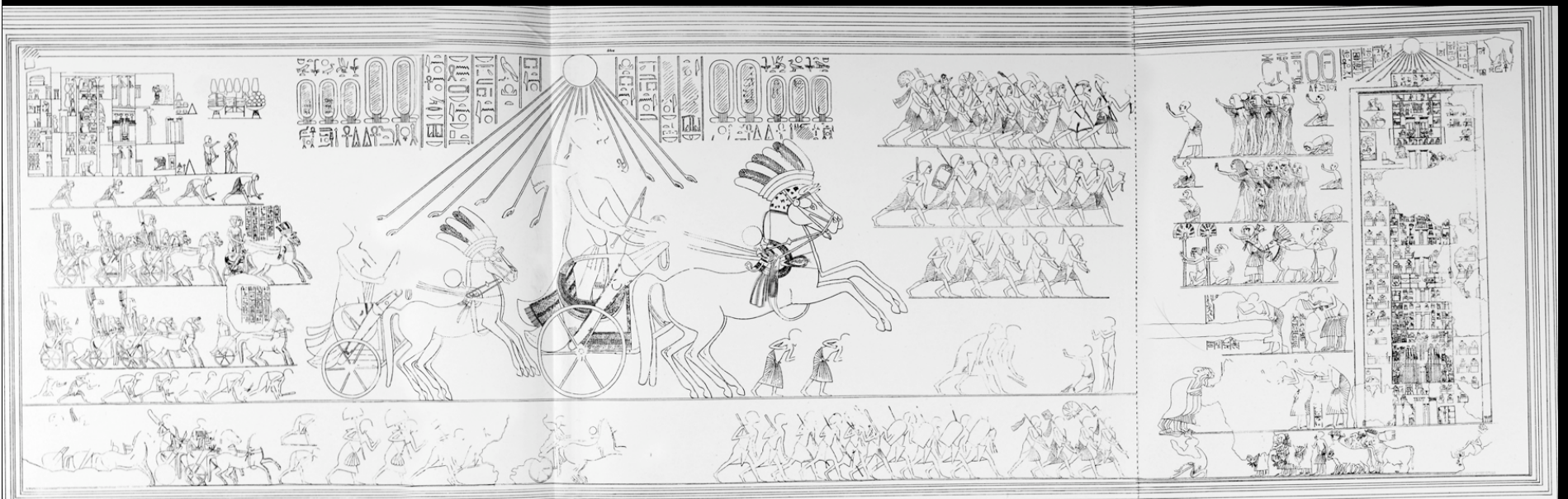

Meryra (High Priest of Aten) pillared hall, west side



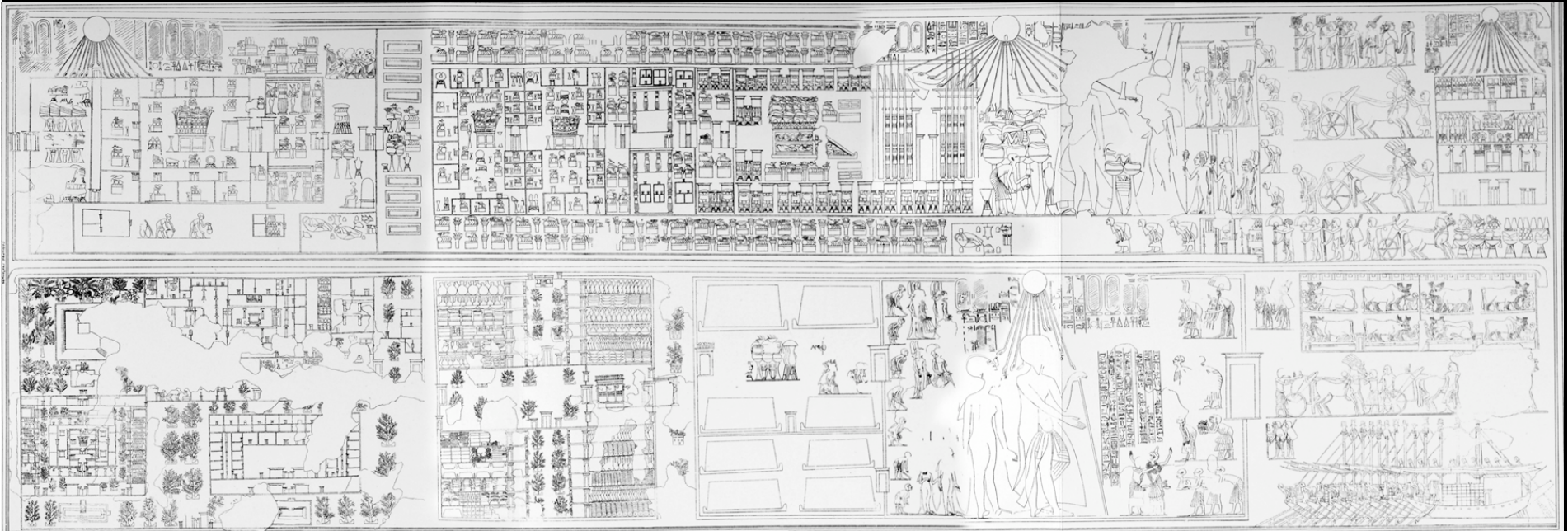

Meryra (High Priest of the Aten) tomb relief, north and east walls

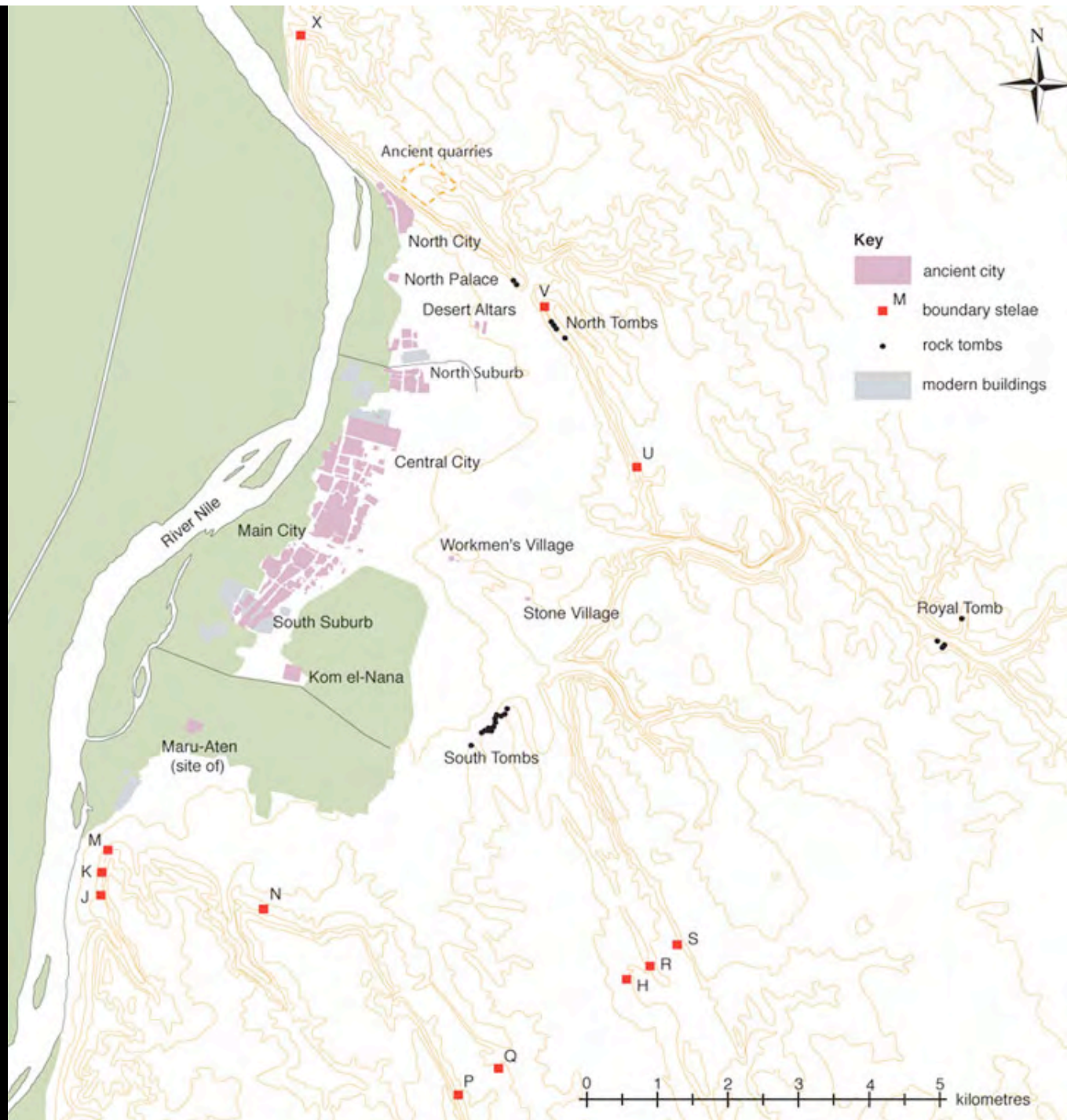





## The North City

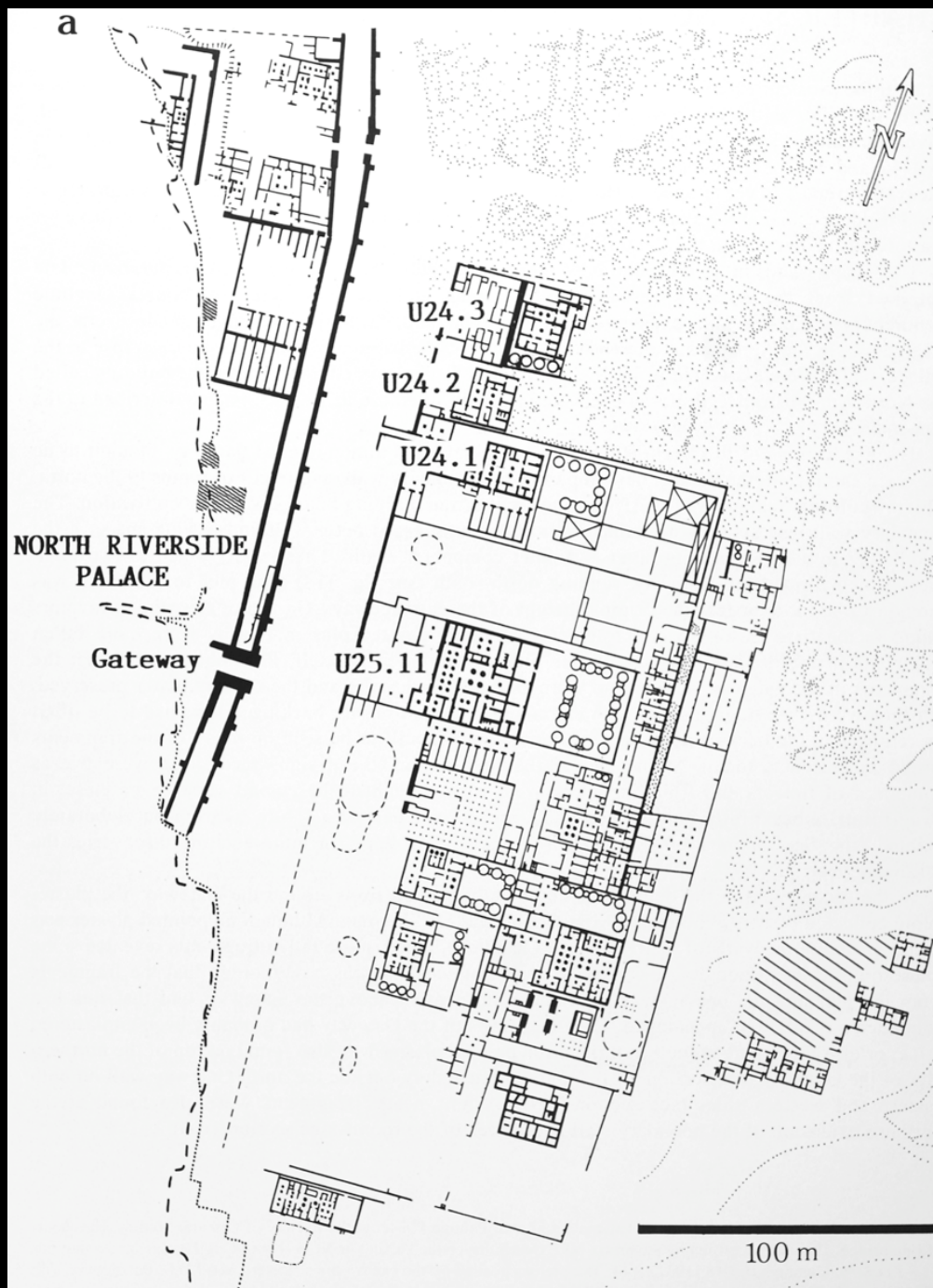



## Monumental gateway at the North Riverside Palace

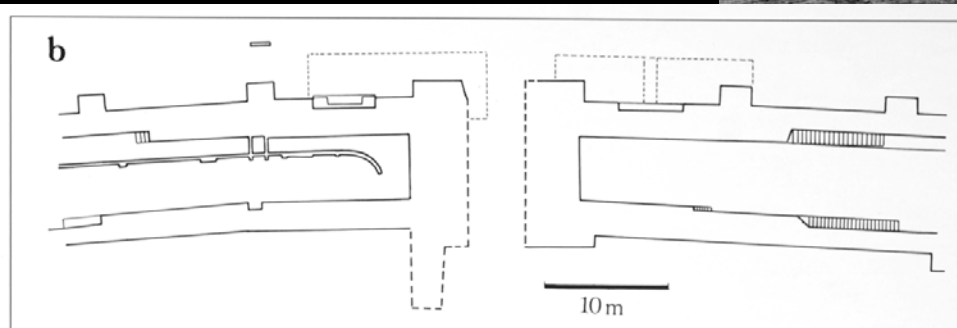
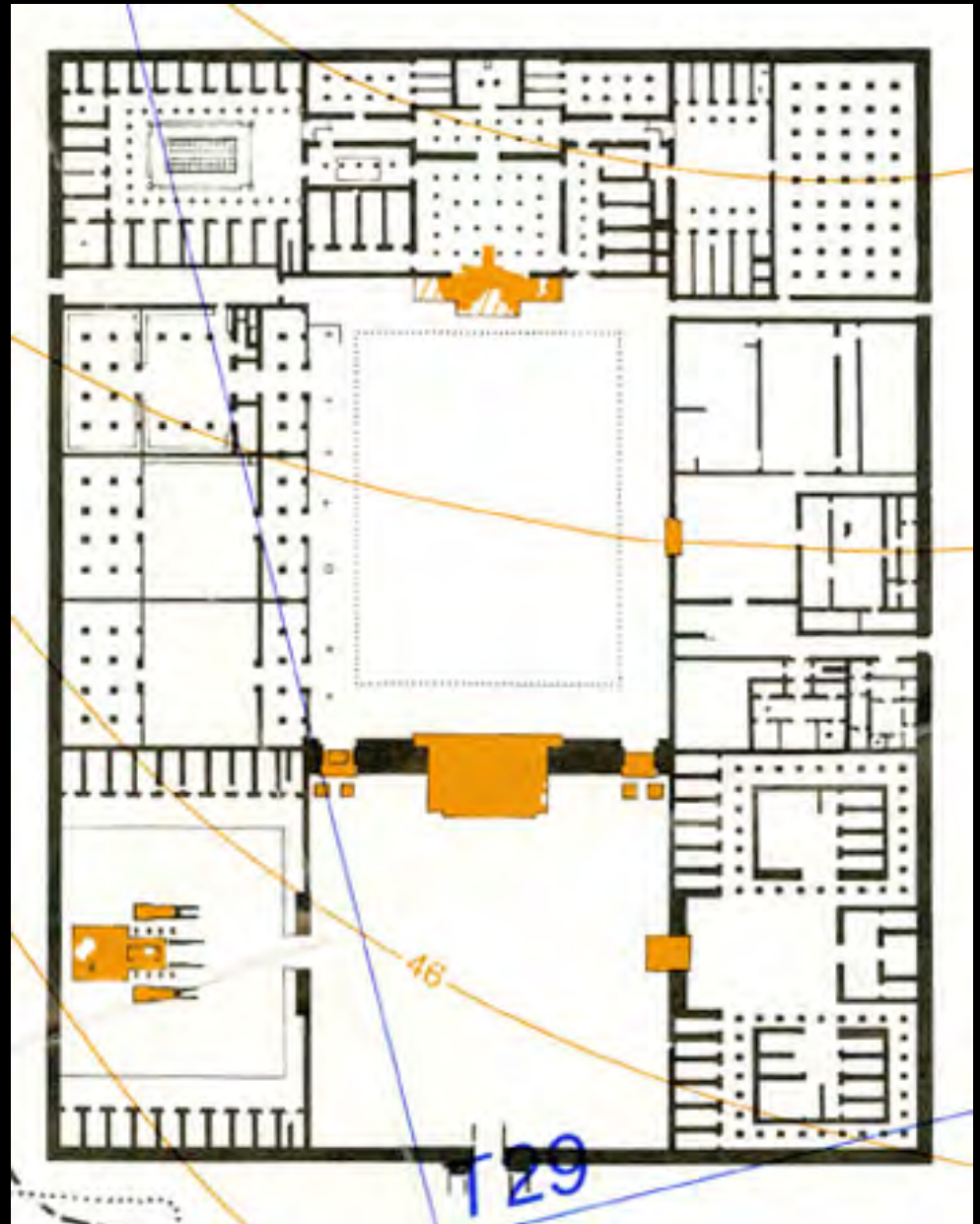

Fig. 118b. Detail of Gateway of North Riverside Palace. Dotted lines indicate reconstructed areas on plan (after unpublished drawing by B. Kemp).



The North Palace







The North Palace

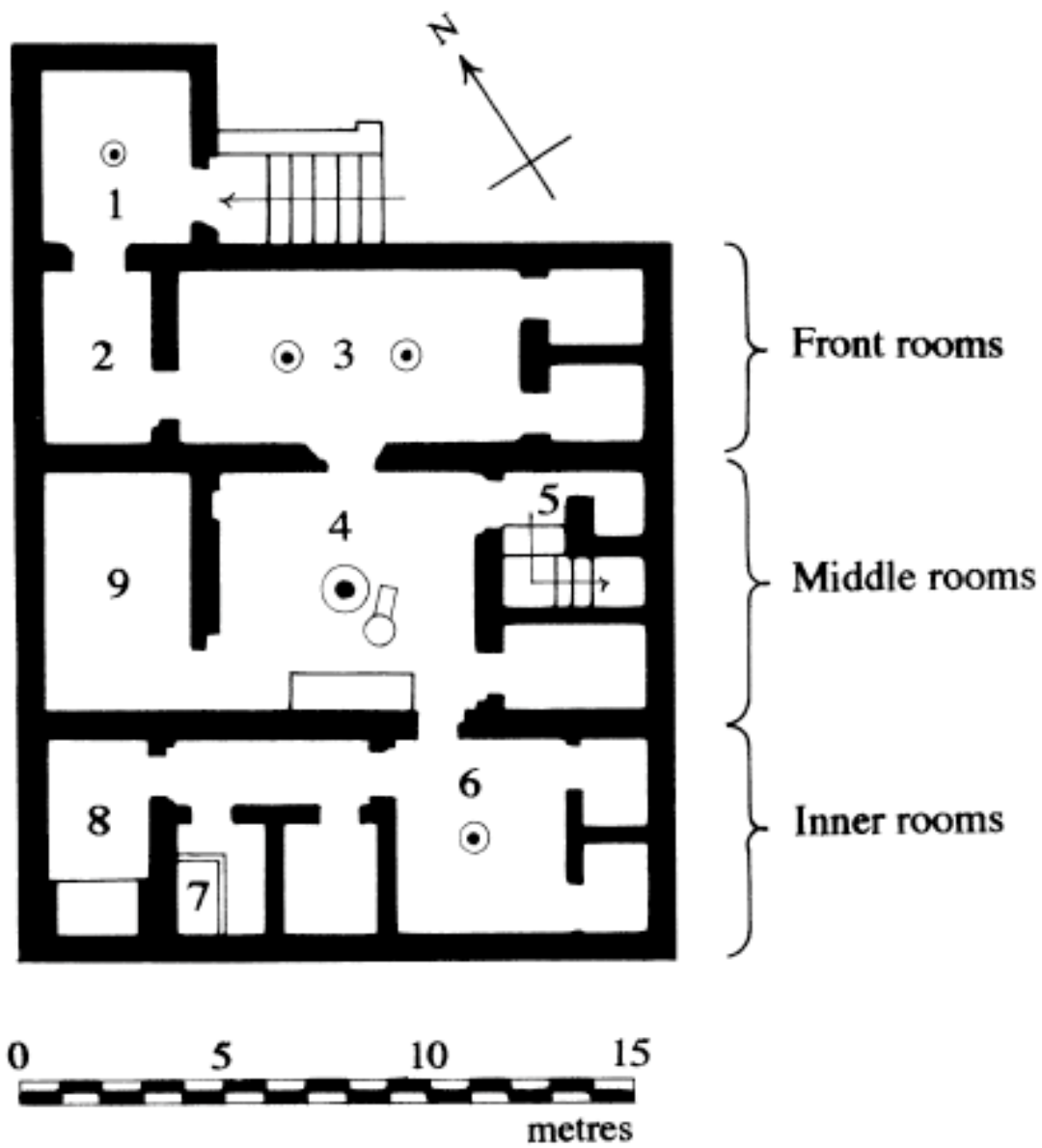

“Standard” Amarna  
House Plan





Parts of the Main City

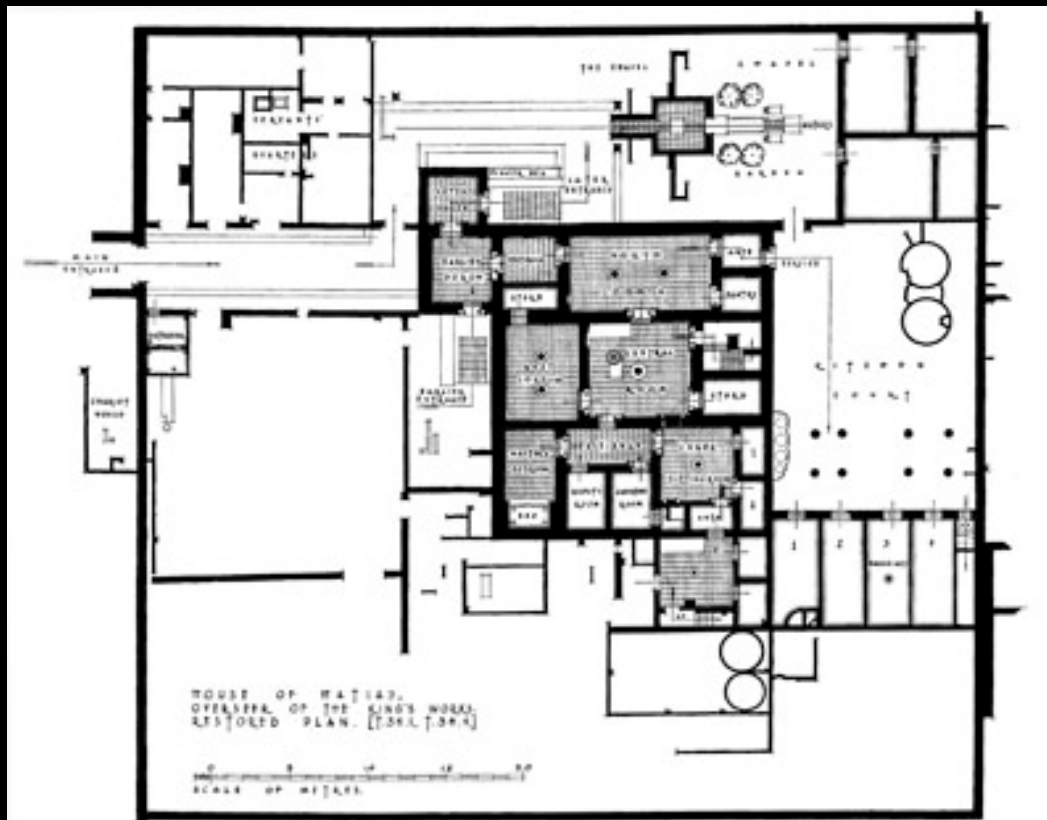

House of the Chief  
Builder, Hatia, North  
Suburb





## Workmen's Village houses

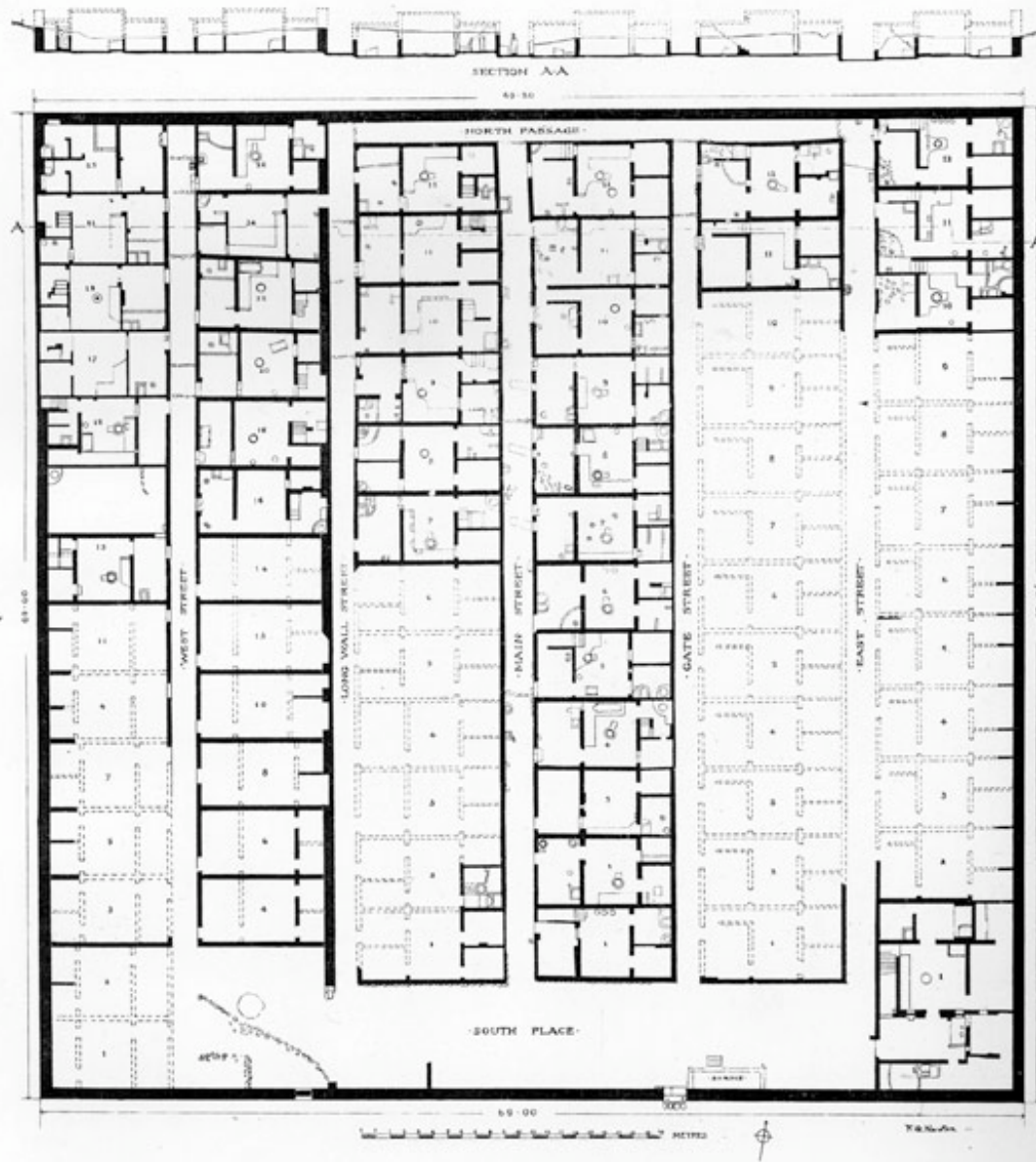

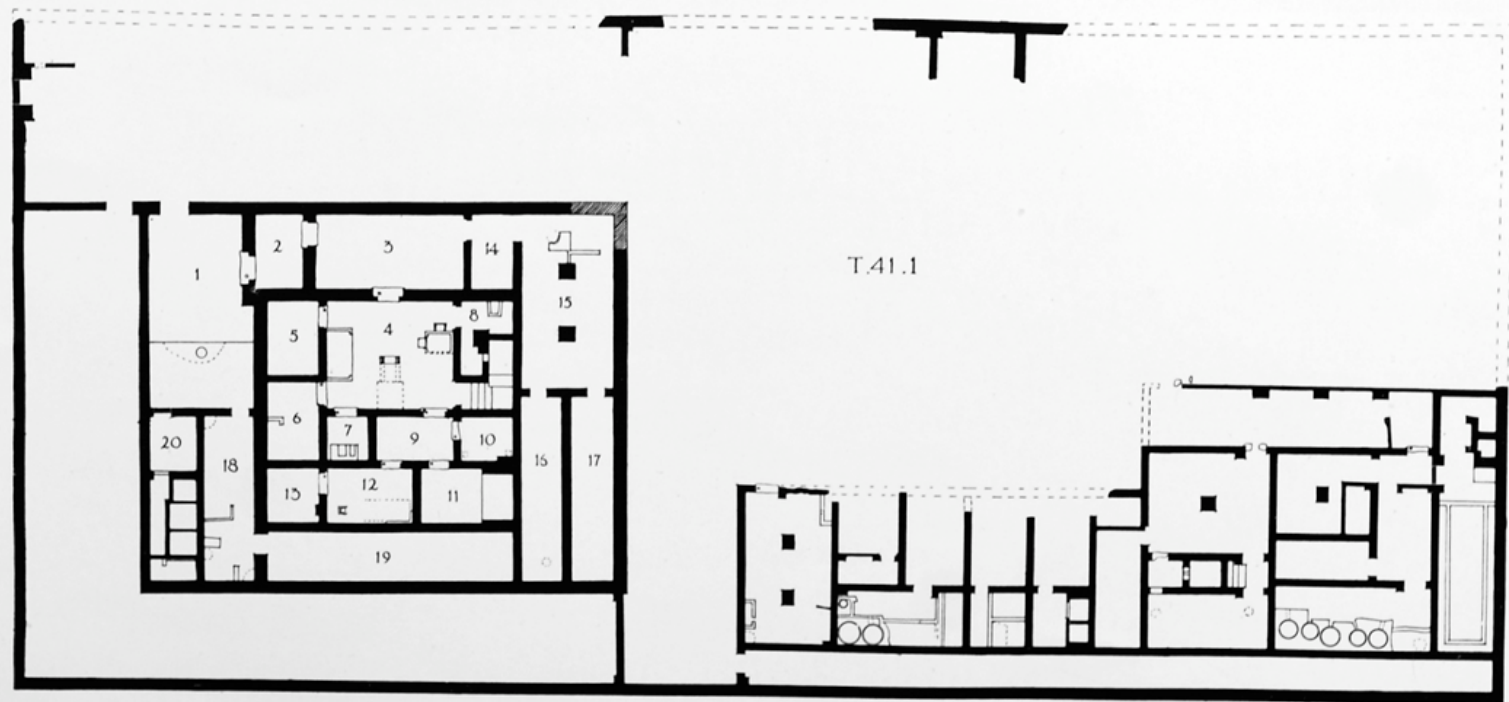

— THE OFFICIAL RESIDENCE OF PANEHSY —  
 CHIEF SERVITOR, & SUPERINTENDENT OF THE CATTLE, OF THE ATEN

— SCALE 1:375

H.B. CLARK DEC 1926 —

Architectural emplacements for private religious practice at Amarna: Altars and Shrines



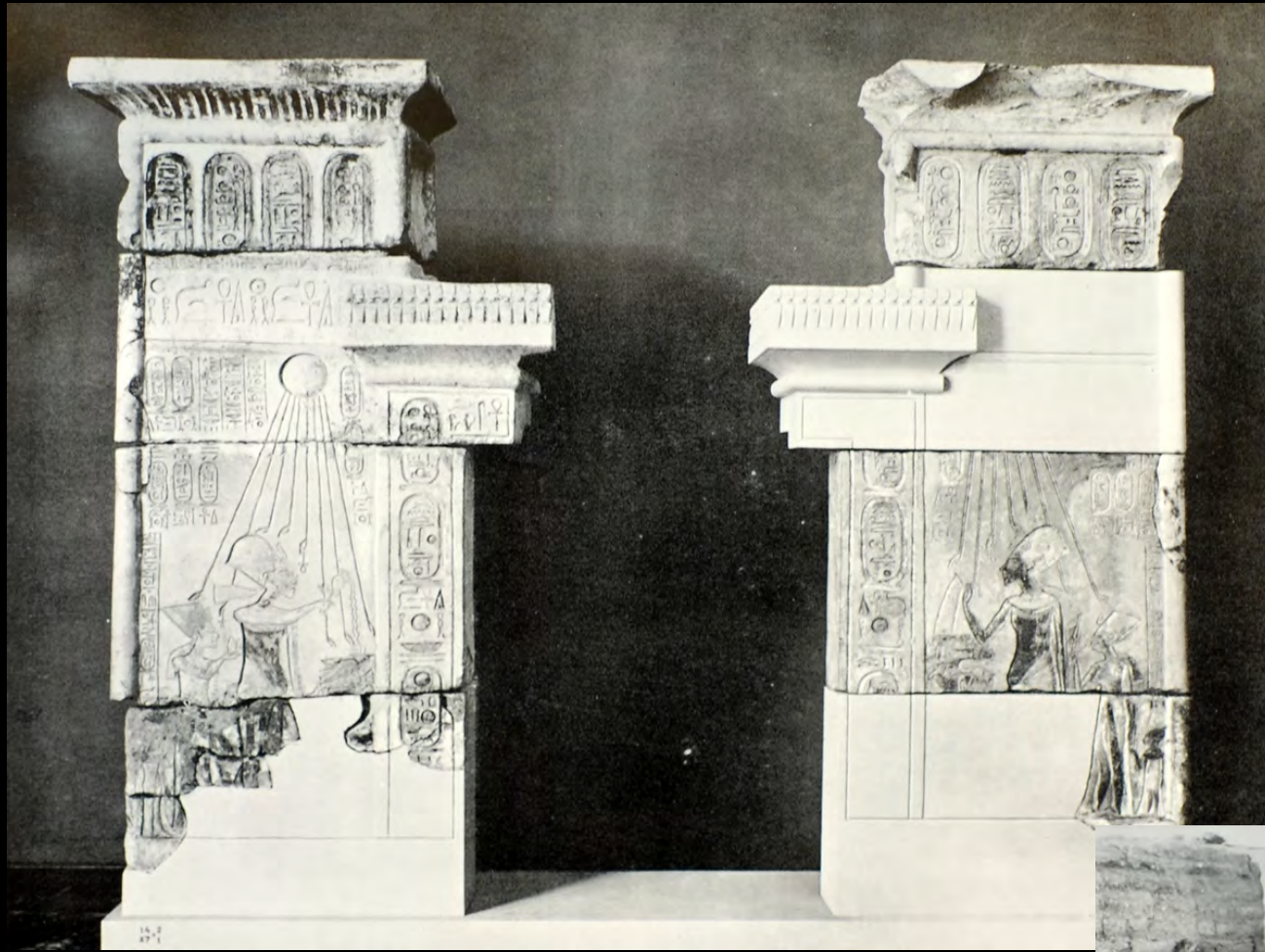

Shrine in the house of Panehsy (his  
“official house” in the Central City)







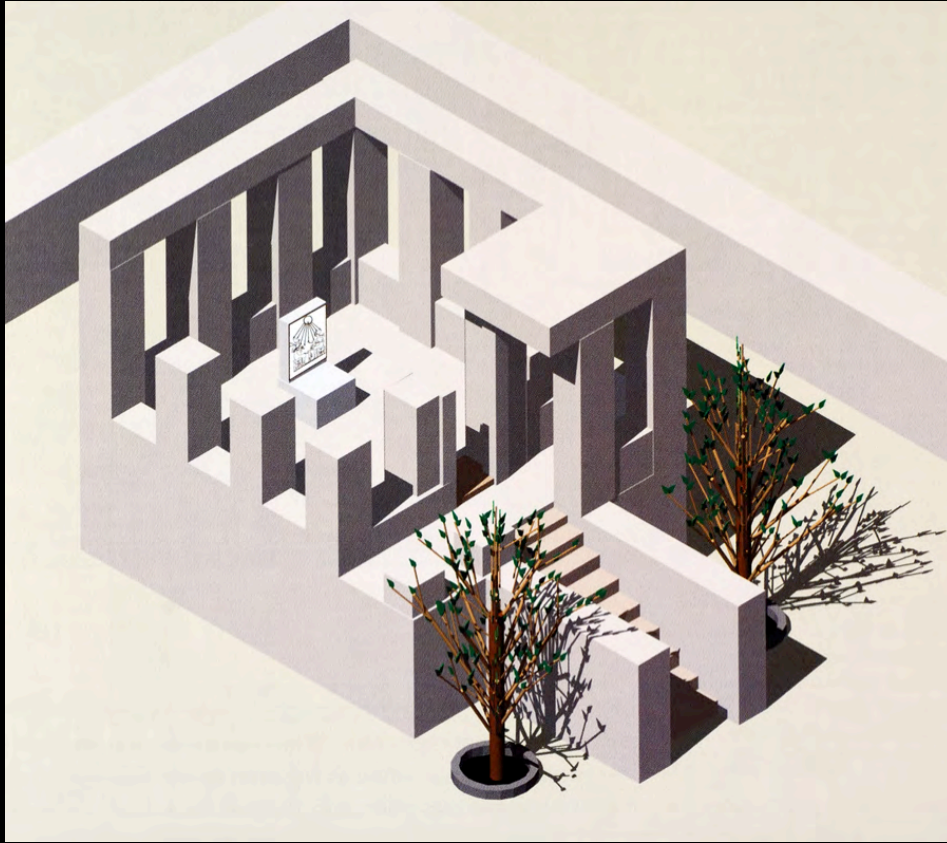

Private garden shrine at Amarna, reconstruction

Private stela showing  
Amenotep III and Tiye, from  
Amarna

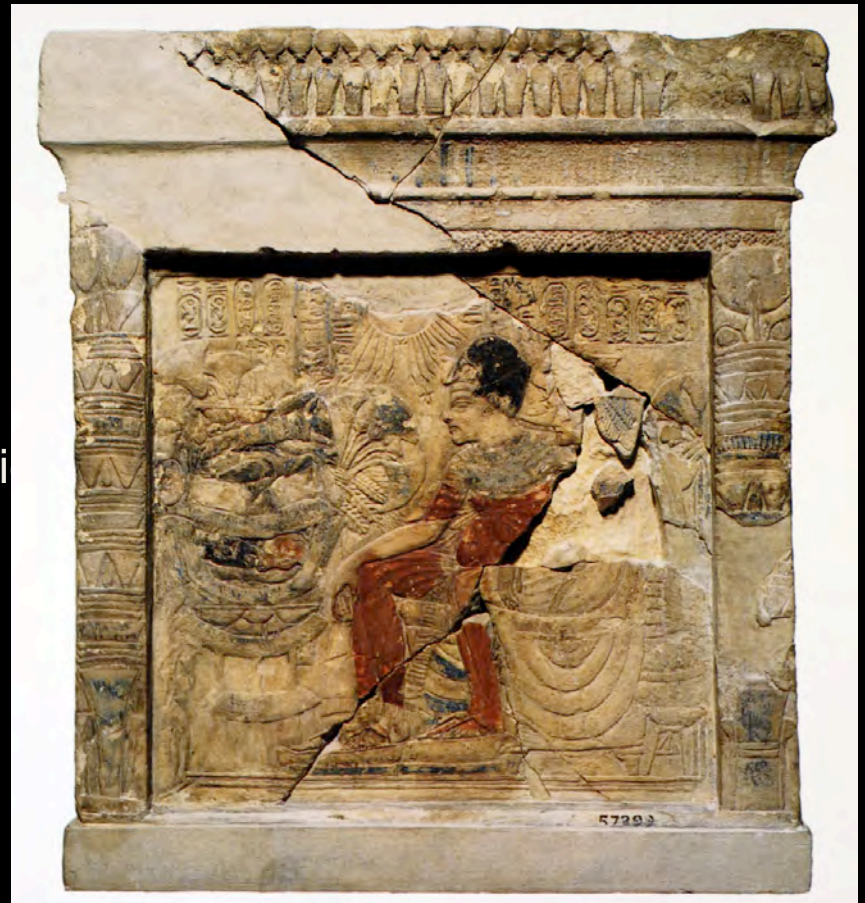



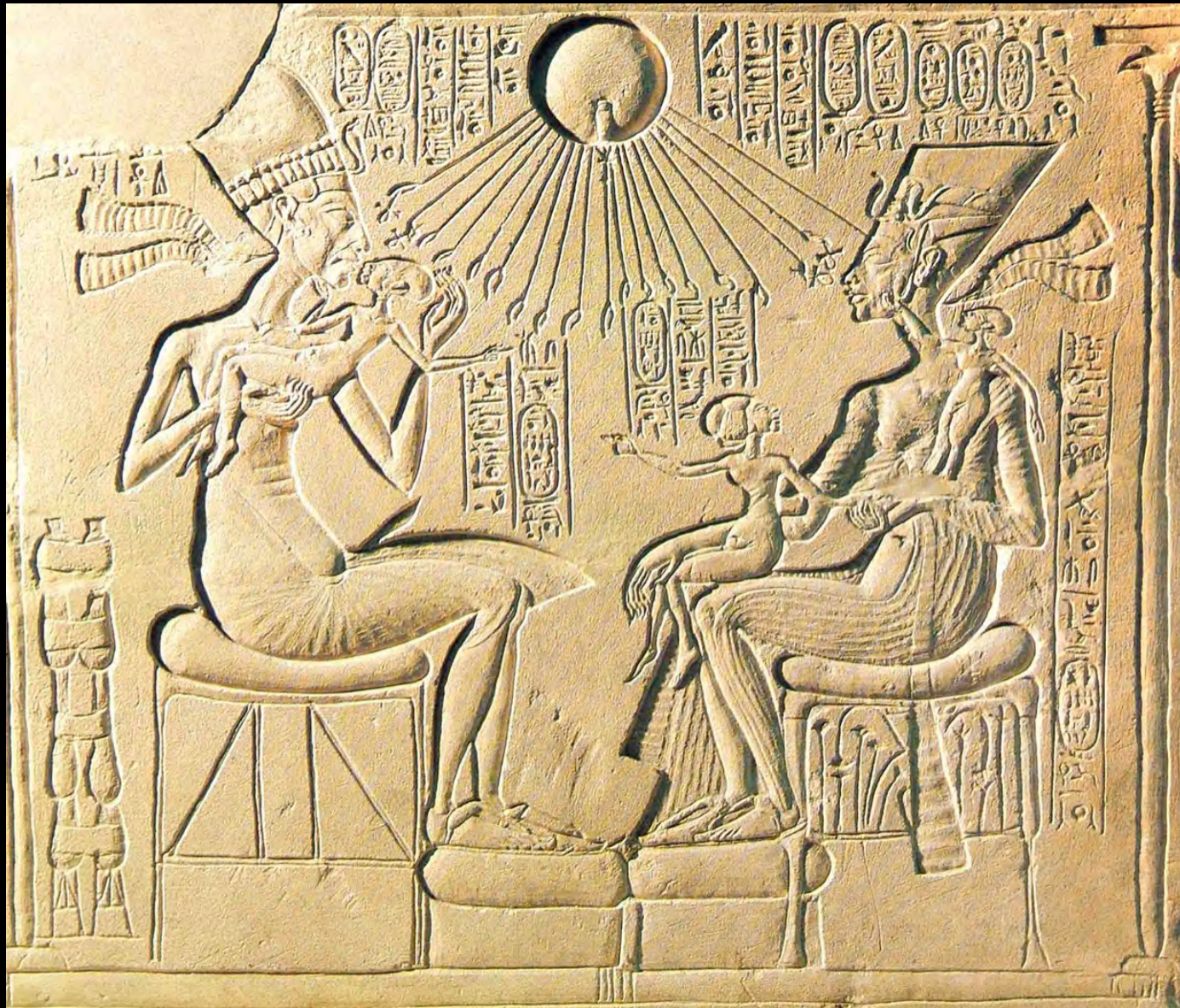

Stela from a Garden Shrine





Artifacts of domestic religion from Amarna



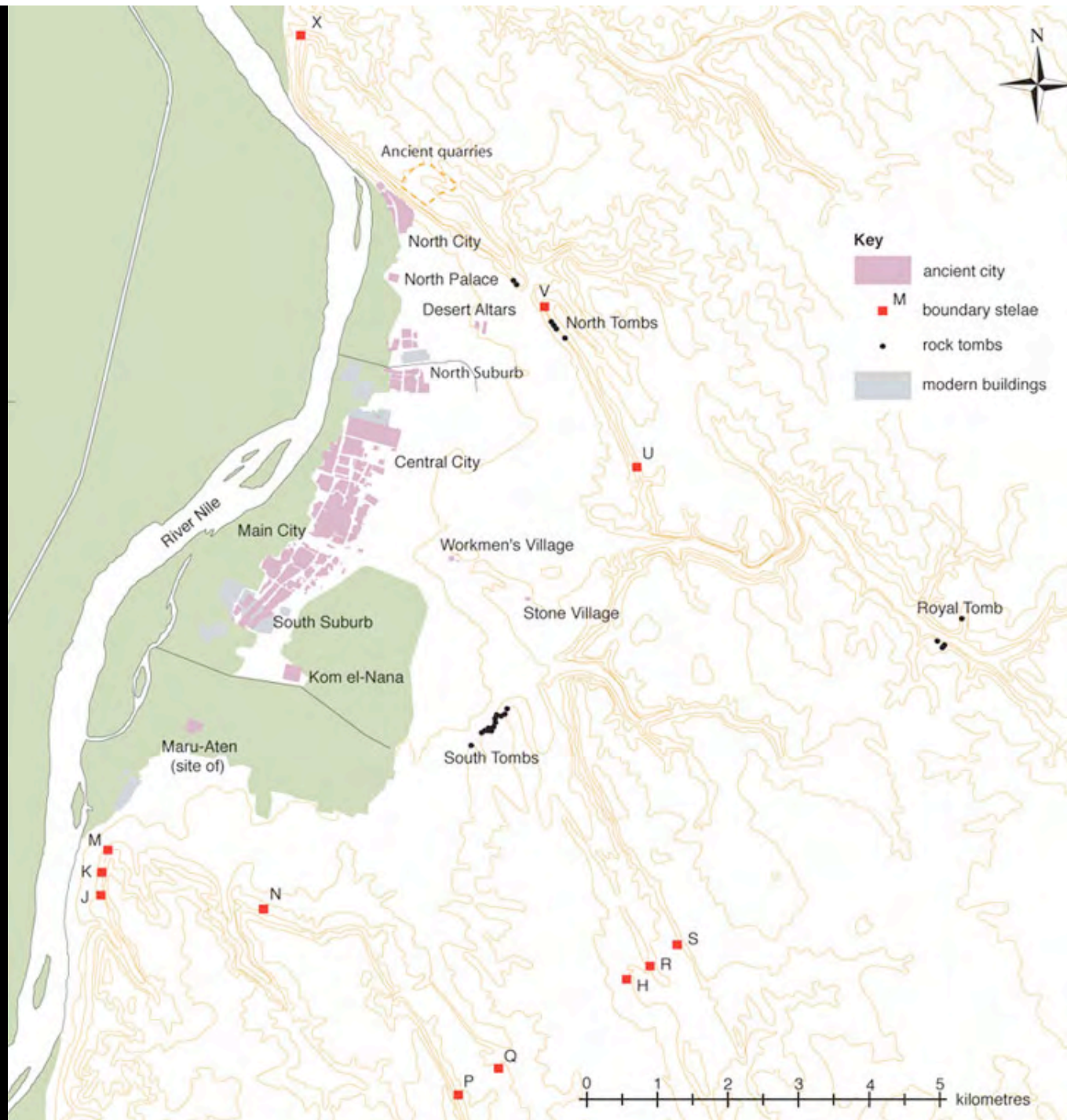



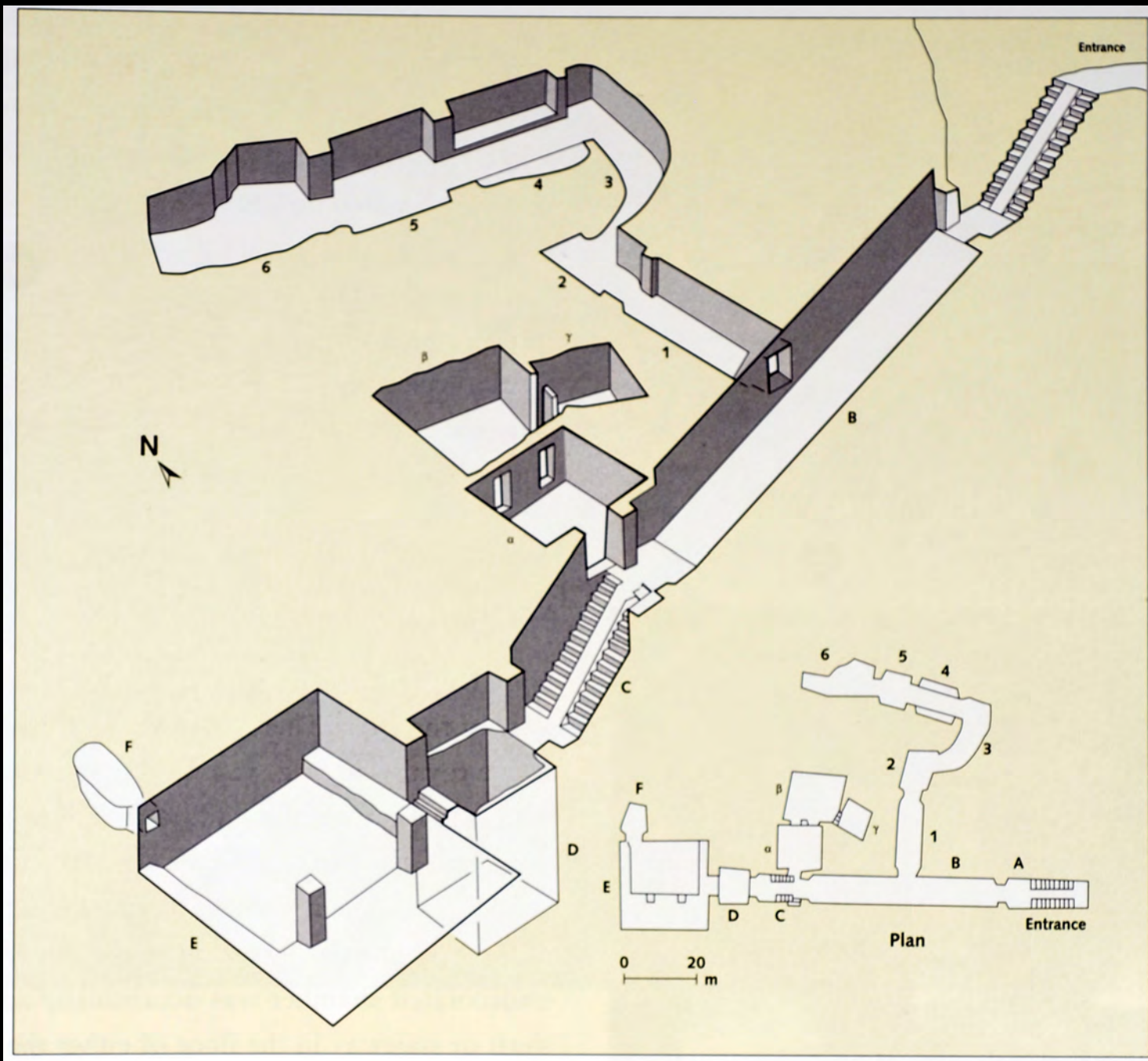



Burial Chamber with  
sarcophagus emplacement

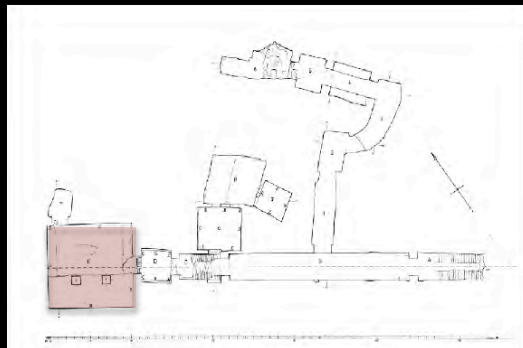



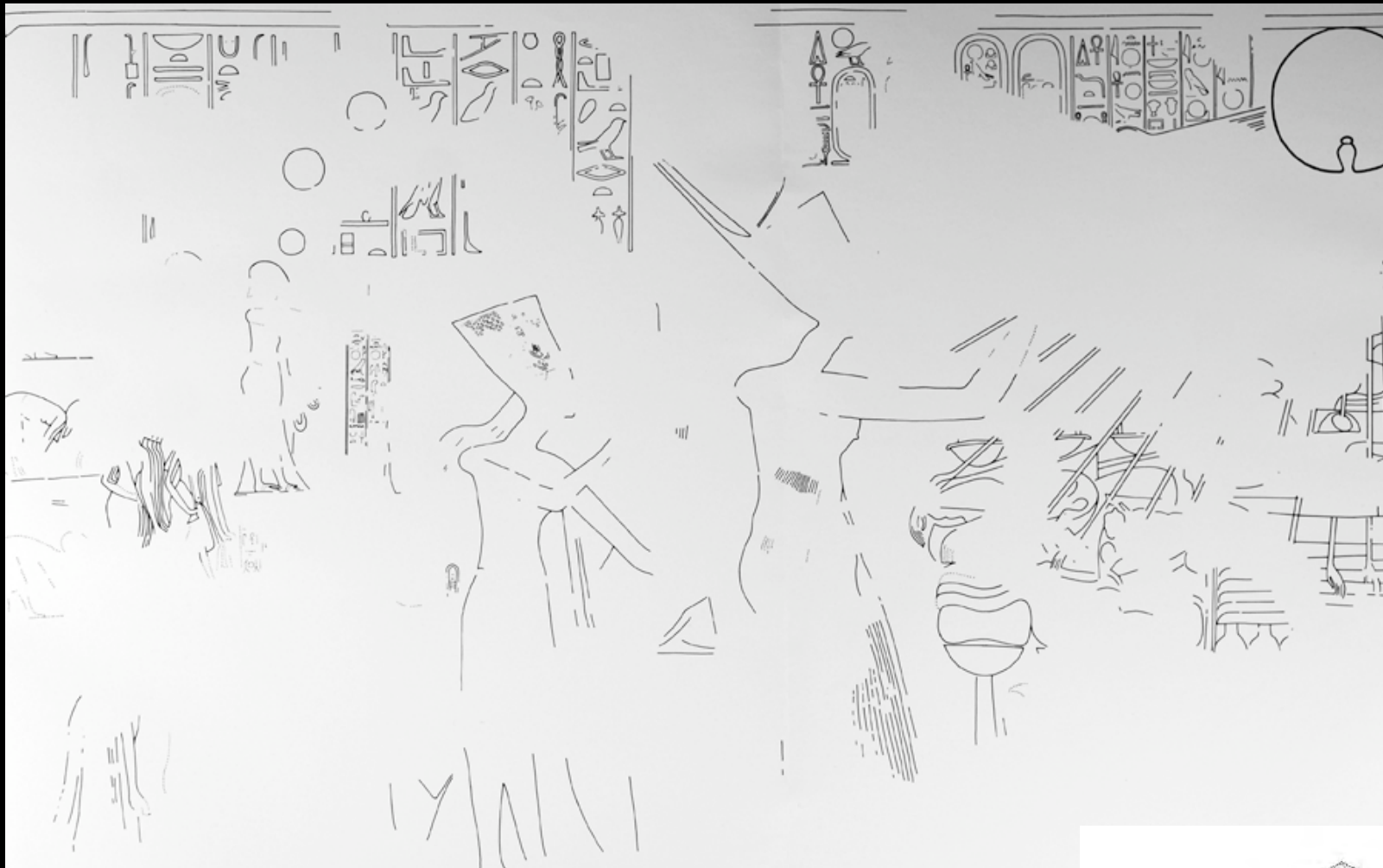

Pillared Hall E: wall A

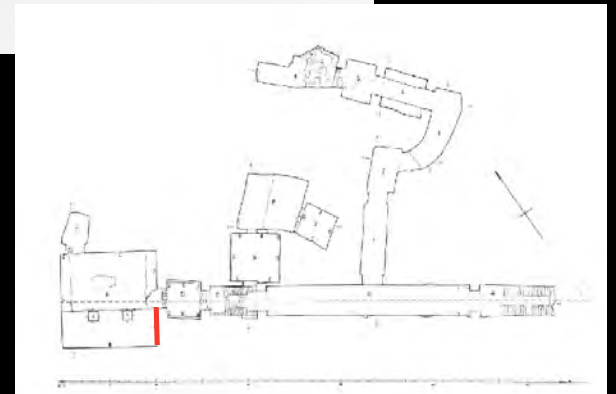

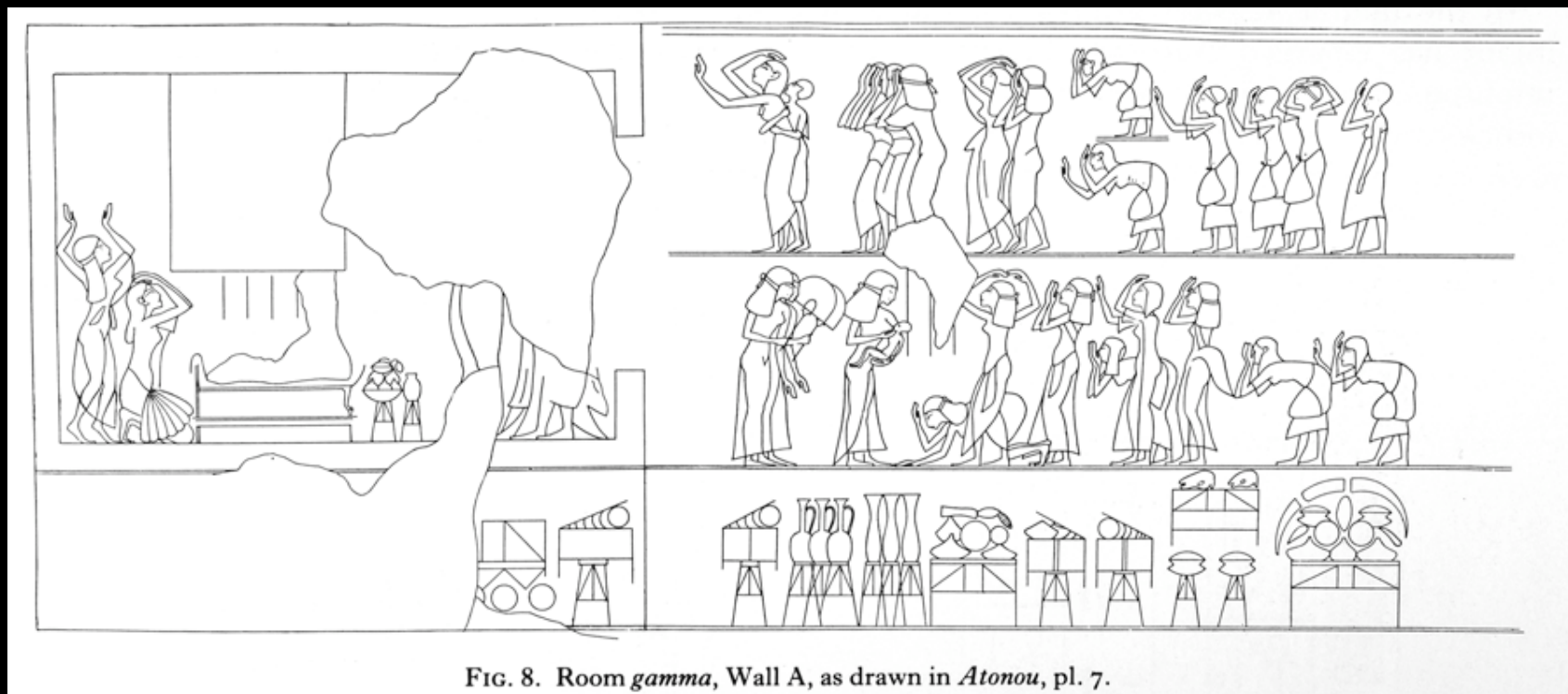

FIG. 8. Room gamma, Wall A, as drawn in *Atonou*, pl. 7.

