

Mecca, Medina and Muhammad



Sources for the study of early Islam

- *Quran*
- *Sira* – the prophetic biographies (mostly later accounts)
- *Hadith* – Records of Prophetic sayings and activities
- Contemporaneous non-Muslim accounts
- Archaeological materials

Mecca: Caravan trade and Pilgrimage Center

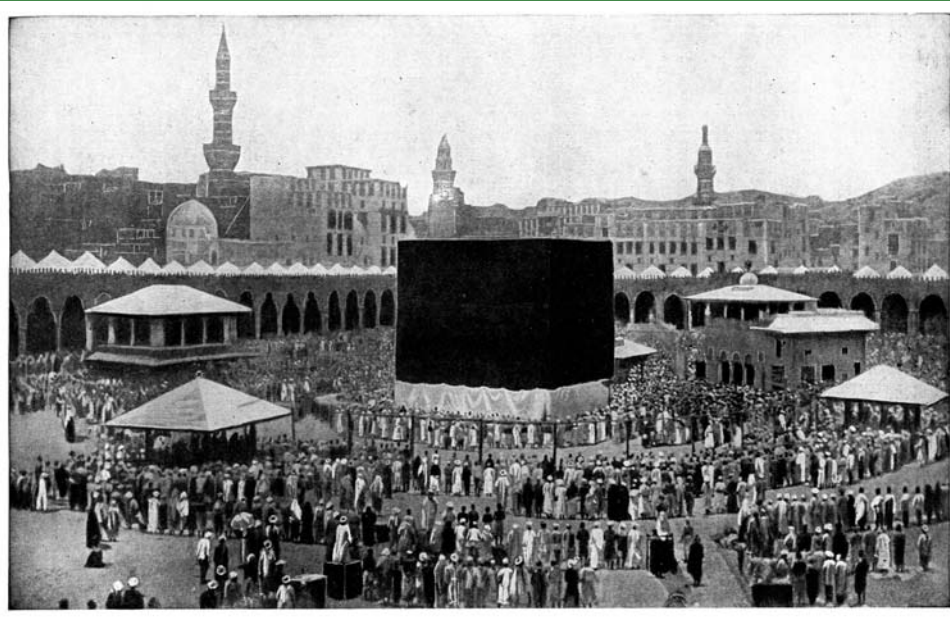

The Prophet Muhammad

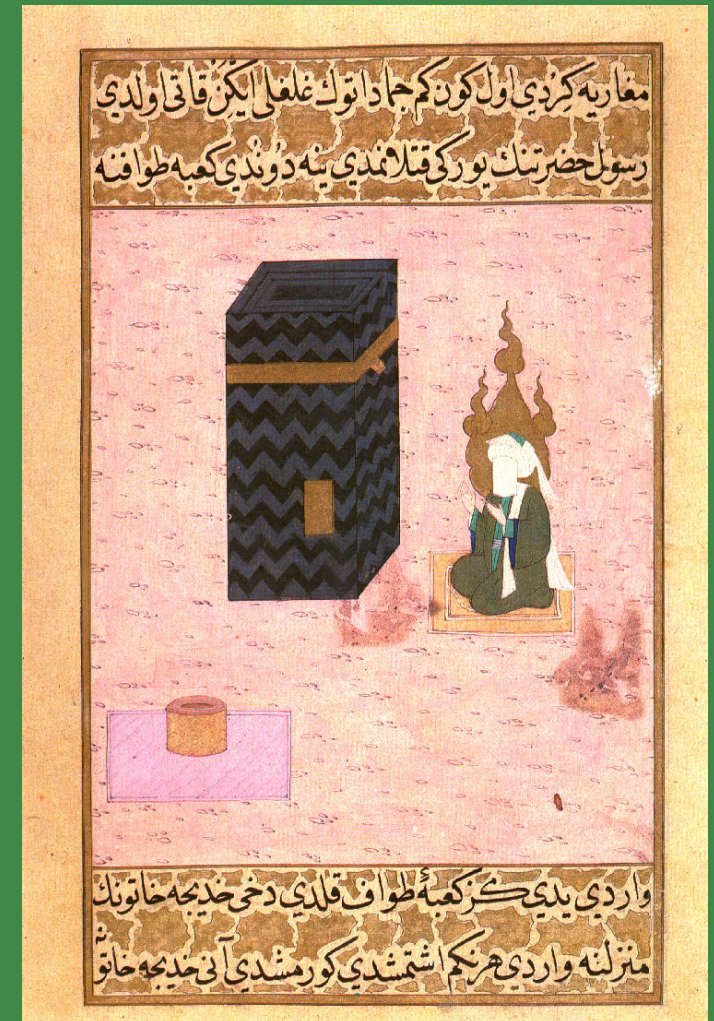
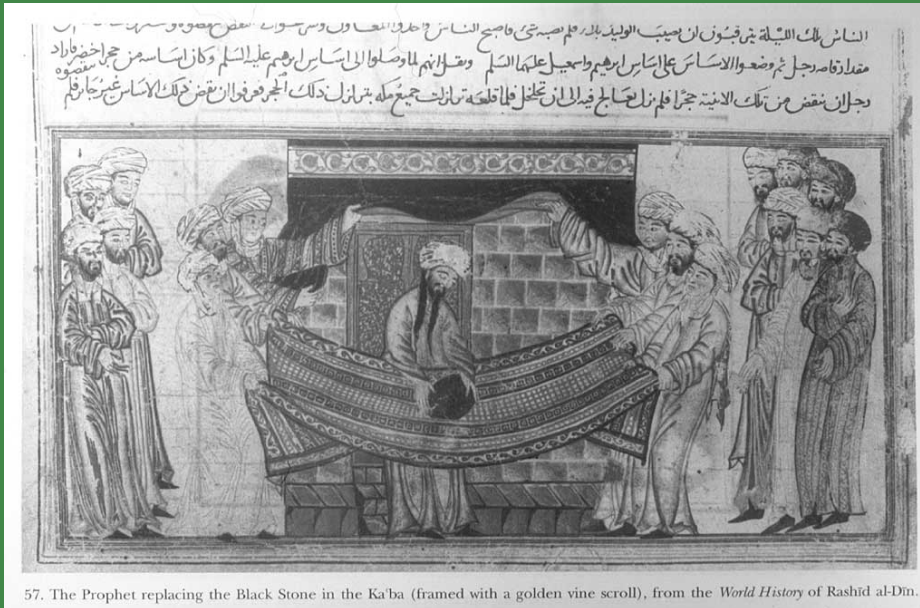

A Timeline of events

- 570 Muhammad's Birth and Infancy
- 575 Muhammad Becomes an Orphan
- 578 Muhammad in Mecca in Care of an Uncle
- 580-594 Muhammad's Teens
- 594 Muhammad Acts as Caravan Agent for Wealthy Tradeswoman, Khadija
- 595-609 Muhammad's Marriage and Family Life
- 610 Muhammad Receives First Revelation
- 613 Muhammad Takes his Message Public
- 622 Muhammad and the Muslims Emigrate to Medina
- 625-628 The Military Period
- 630 The Conquest of Mecca
- 630-632 Muhammad's Final Years

From Yathrib to Medina

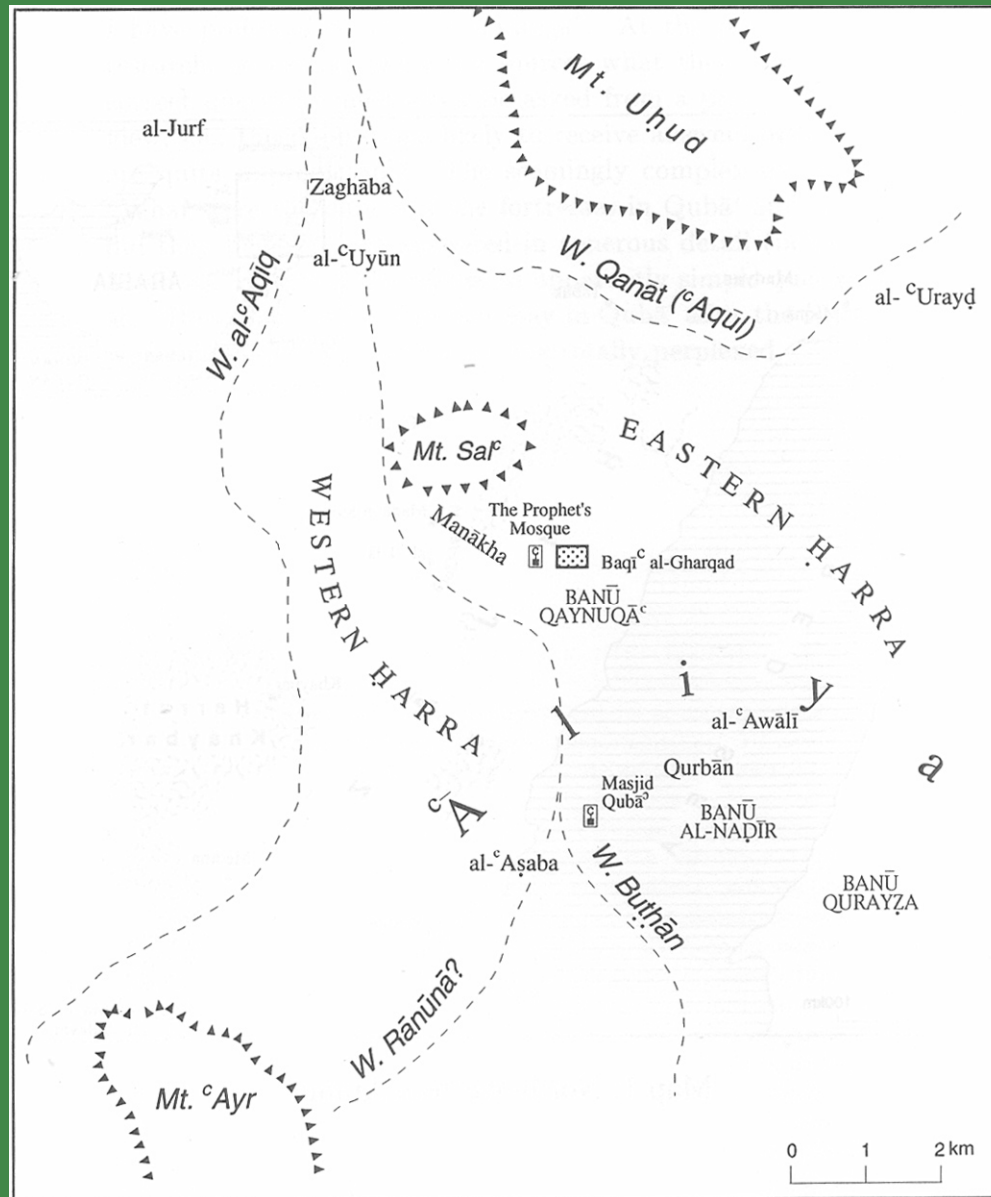

The Atam/utum of Medina

- Clan based structures
- Medina would undergo a social and physical transformation under Muhammad
- Landscape of Yathrib also composed of several fortresses (*husun*) – particularly held by the Jewish tribes.



Image: Yemini “tower-house” which may be related to the form of the *atam*

THE 'HOUSE OF THE PROPHET' AND THE CONCEPT OF THE MOSQUE

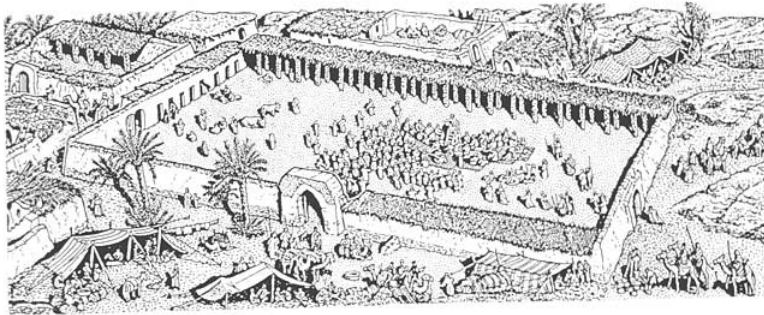
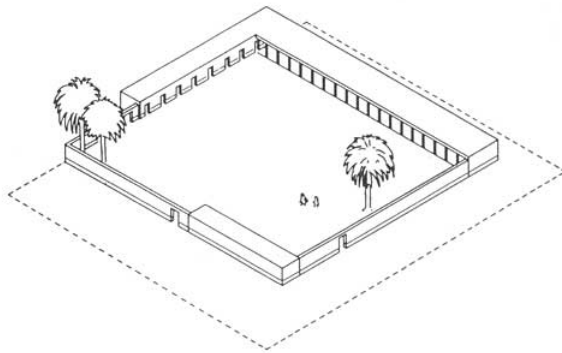
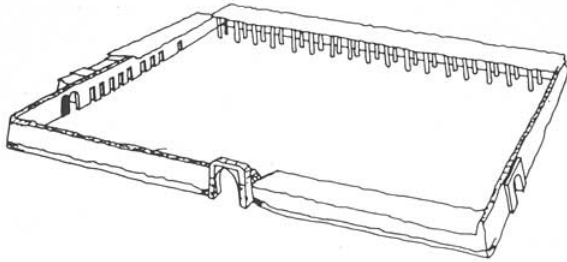

15. Isometric reconstructions of the Prophet's house:

(Top to bottom: after Hillenbrand 1994; Kuban 1974; Leacroft & Leacroft 1976)

Masjid al-Nabi (The mosque of the Prophet):



Parallel Developments of the Mosque as an institution

